

**NINGBO MOTEIPH METAL CO.,LTD.**

## COMPANY PROFILE

---

We established Ningbo Moteph Metal(MTM) in 2015 for selling rigging hardware that later grew to one of the leading trading companies. For clients worldwide, MTM provides rigging hardware, chains, ropes, fasteners, marine hardware, OEM stamping and other casting machining parts. Adhering to the principle of prioritizing quality first and customer-oriented, we have earned the great reputation in this field.

MTM provides the following products with carbon steel, stainless steel and other materials:

- **Shackles**
- **Wire rope clips**
- **Swivels**
- **Hooks**
- **Chains & Ropes**
- **Turnbuckles**
- **Thimbles**
- **Eye bolts & Eye nuts**
- **Quick links**
- **Swage Terminals**

All the articles standardized in accordance with DIN or ISO and the non-standardized rigging elements are available. Meanwhile, we are happy to supply you with the parts which are special as regards their samples and drawings, also customized in line with your requirements. Detailed information about the specifications, materials, standards can be found in the full catalogue and on the website.

And for those who want even more on fasteners: Wood construction screw; Chipboard Screw, Decking screw; Terrace screw; Concrete screw; Self tapping screw; Self drilling screw; Machine screw and much more will soon be coming on board.

We trust our products will contribute to continuously strengthening and extension of existing cooperation to mutual benefit and satisfaction.

# INDEX

## Carbon Steel Rigging

※ Shackles .....	1~2
※ Turnbuckles .....	3~6
※ Wire Rope Clips .....	7~9
※ Thimbles .....	10~11
※ Eye Bolts, Eye Nuts, Swivles .....	12~16
※ Hooks, Quick Links .....	17~25
※ Chains, Ropes, Pulleys, Wire Stretchers .....	26~29

## Stainless Steel Rigging

※ Shackles .....	30~32
※ Turnbuckles .....	33~34
※ Wire Rope Clips, Thimbles .....	35~36
※ Eye Bolts, Eye Nuts, Thread Screws, Swivels .....	37~39
※ Hooks, Quick Links .....	40~43
※ Swage Terminals, Rings, Buckles, Hinges .....	44~48
※ Plates .....	49~51
※ Chains .....	52



### MTM 0101 European Type Dee Shackle

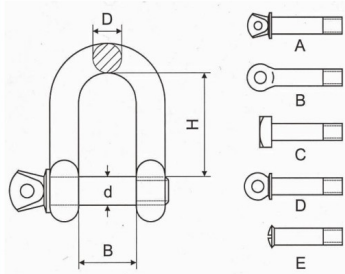

Size(D) mm	4	5	6	8	10	11	12	14	16	18
d	4	5	6	8	10	11	12	14	16	18
B	8	10	12	16	20	22	25	28	32	36
H	16	19	24	32	40	44	48	56	64	71
Size(D) mm	19	22	25	28	32	36	38	42	45	50
d	19	22	25	28	32	36	38	42	45	50
B	38	44	50	56	64	70	76	80	89	90
H	76	85	95	106	120	130	145	145	155	175

Material: Carbon steel

### MTM 0102 European Type Bow Shackle

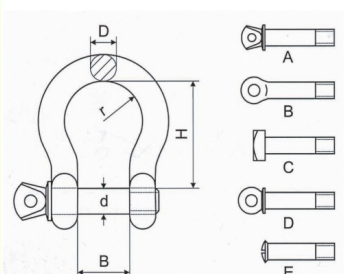

Size(D) mm	5	6	8	10	11	12	14	16
d	5	6	8	10	11	12	14	16
B	10	12	16	20	22	25	28	32
H	19.5	24	32	40	44.5	49	59	64
2r	15	18	24	30	33	36	42	48
Size(D) mm	18	19	22	25	28	32	36	38
d	18	19	22	25	28	32	36	38
B	36	38	44	50	56	64	70	76
H	71	80	85	100	116	129	138	151
2r	54	60	66	75	86	96	106	114

Material: Carbon steel

### MTM 0103 DIN 82101 Shackle

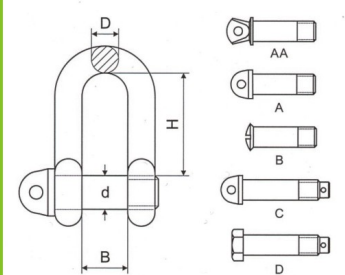

Size(Dxd) mm	5X5	6X6	8X8	10X10	12X12
B	7	8	11	14	17
H	15.5	18	24	30	36
Size(Dxd) mm	13X16	16X20	20X22	22X25	25X28
B	21	27	30	33	38
H	49	61	67	72	83
Size(Dxd) mm	28X30	32X36	36X39	42X45	45X48
B	42	47	53	60	66
H	90	111	120	139	147

Material: Carbon steel

### MTM 0104 U.S. Type Bow Shackle G209

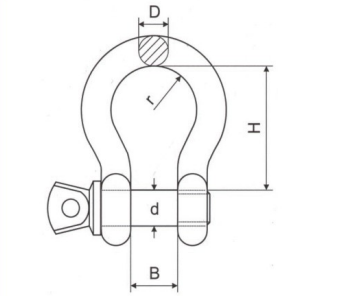

Size(Dxd) in	3/16"x1/4"	1/4"x5/16"	5/16"x3/8"	3/8"x7/16"
B(MM)	10	13	14	17
H(MM)	22	28	31	37
2r(MM)	16	20	21	26
Size(Dxd) in	7/16"x1/2"	1/2"x5/8"	5/8"x3/4"	3/4"x7/8"
B(MM)	18	21	27	32
H(MM)	43	48	60	71
2r(MM)	29	33	43	51
Size(Dxd) in	7/8"x1"	1"x1-1/8"	1-1/8"x1-1/4"	1-1/4"x1-3/8"
B(MM)	37	43	46	51
H(MM)	84	95	108	119
2r(MM)	58	68	74	82
Size(Dxd) in	1-3/8"x1-1/2"	1-1/2"x1-5/8"		
B(MM)	57	60		
H(MM)	132	146		
2r(MM)	90	98		

Material: Material of Body: C45  
Material of Pin: 40Cr

## MTM 0105 U.S. Type Bow Shackle G2130

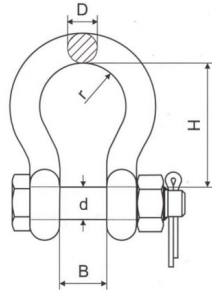

Size(Dxd) in	3/16"x1/4"	1/4"x5/16"	5/16"x3/8"	3/8"x7/16"	7/16"x1/2"
B(MM)	10	13	14	17	18
H(MM)	22	28	31	37	43
2r(MM)	16	20	21	26	29
Size(Dxd) in	1/2"x5/8"	5/8"x3/4"	3/4"x7/8"	7/8"x1"	1"x1-1/8"
B(MM)	21	27	32	37	43
H(MM)	48	60	71	84	95
2r(MM)	33	43	51	58	68
Size(Dxd) in	1-1/8"x1-1/4"	1-1/4"x1-3/8"	1-3/8"x1-1/2"	1-1/2"x1-5/8"	
B(MM)	46	51	57	60	
H(MM)	108	119	132	146	
2r(MM)	74	82	90	98	

Material: Material of Body: C45  
Material of Pin: 40Cr

## MTM 0106 U.S. Type Dee Shackle G210

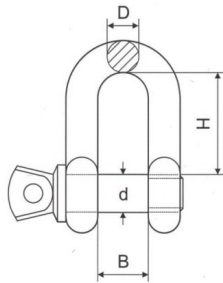

Size(Dxd)IN	3/16"x1/4"	1/4"x5/16"	5/16"x3/8"	3/8"x7/16"	7/16"x1/2"
B(MM)	10	13	14	17	18
H(MM)	19	22	26	32	36
Size(Dxd)IN	1/2"x5/8"	5/8"x3/4"	3/4"x7/8"	7/8"x1"	1"x1-1/8"
B(MM)	21	27	32	37	43
H(MM)	41	51	60	71	81
Size(Dxd)IN	1-1/8"x1-1/4"	1-1/4"x1-3/8"	1-3/8"x1-1/2"	1-1/2"x1-5/8"	
B(MM)	46	51	57	60	
H(MM)	90	100	111	122	

Material: Material of Body: C45  
Material of Pin: 40Cr

## MTM 0107 U.S. Type Dee Shackle G2150

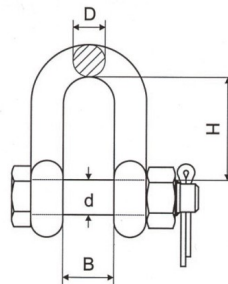

Size(Dxd) in	3/16"x1/4"	1/4"x5/16"	5/16"x3/8"	3/8"x7/16"
B(MM)	10	13	14	17
H(MM)	19	22	26	32
Size(Dxd) in	7/16"x1/2"	1/2"x5/8"	5/8"x3/4"	3/4"x7/8"
B(MM)	18	21	27	32
H(MM)	36	41	51	60
Size(Dxd) in	7/8"x1"	1"x1-1/8"	1-1/8"x1-1/4"	1-1/4"x13/8"
B(MM)	37	43	46	51
H(MM)	71	81	90	100
Size(Dxd) in	1-3/8"x1-1/2"	1-1/2"x1-5/8"		
B(MM)	57	60		
H(MM)	111	122		

Material: Material of Body: C45  
Material of Pin: 40Cr

## MTM 0108 Twisted Shackle

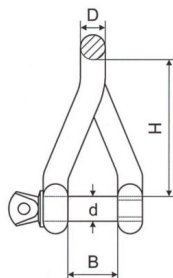

Size(D) mm	4	5	6	8	10	12
d	4	5	6	8	10	12
B	8	10	12	16	20	25
H	23	28	37	42	55	68

Material: Carbon steel





### MTM 0201 Turnbuckle DIN1480 By Forged

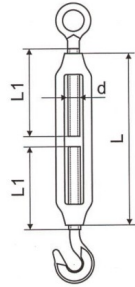

Size (d)	M5	M6	M8	M10	M12	M14	M16
L (mm)	70	110	110	125	125	140	170
L1 (mm)	35	55	57	68	70	75	88
Size (d)	M20	M22	M24	M27	M30	M36	M42
L (mm)	200	220	255	255	255	295	330
L1 (mm)	105	118	135	135	135	158	170

Material: Carbon steel

### MTM 0202 Turnbuckle DIN1480 Eye and Jaw

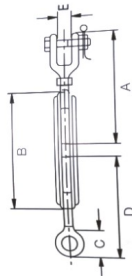

Size	M6	M8	M10	M12	M14	M16	M20	M22
A	101	110	125	138	142	175	213	240
B	110	110	125	125	135	170	200	220
C	20	22	31	35	40	47	52	60
D	80	85	105	111	124	150	168	190
E	7	9	10.5	13	13	18	20	25

Material: Carbon steel

### MTM 0203 Turnbuckle DIN1480 Plane Ends

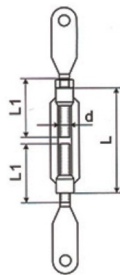
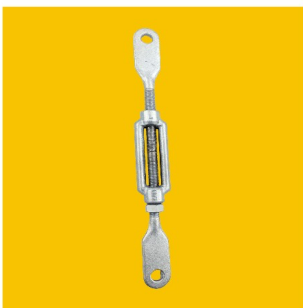

Size (d)	M8	M10	M12	M16	M20	M24
L (mm)	110	125	125	170	200	255
L1 (mm)	70	80	85	110	110	153

Material: Carbon steel

### MTM 0204 Turnbuckle DIN 1480 Stud End

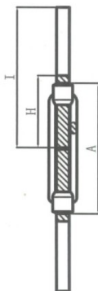
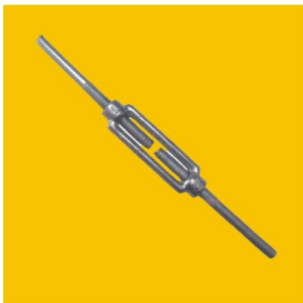

Size (mm)	Diemensions (mm)		
	A	H	I
M6	110	60	120
M8	110	65	120
M10	125	75	150
M12	125	75	150
M14	140	90	165
M16	170	100	200
M20	200	120	220
M22	220	120	220
M24	255	150	260
M27	255	160	265
M30	255	160	260
M36	295	180	300
M42	330	200	350
M48	355	220	380
M56	355	230	380

Material: Carbon steel

## MTM 0205 Turnbuckle DIN 1480 Body Only

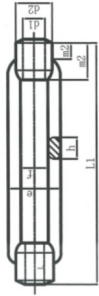

Size (mm)	Diemensions(mm)							
	L1	Adjustable	d2	e	f	h	m1	m2
M6	110	80	12	19	9	6	12	6
M8	110	75	15	23	11	8	15	8
M10	125	85	18	30	14	9	18	9
M12	125	80	21	34	16	11	21	11
M14	140	90	25	38	18	10	24	9
M16	170	110	27	42	20	14	27	14
M20	200	130	34	52	24	17	34	17
M22	220	145	36	57	26	16	37	15
M24	255	170	39	60	28	20	39	20
M30	255	160	45	74	34	23	45	23
M36	295	180	55	86	40	28	55	28
M42	330	200	63	104	50	32	63	32
M48	355	195	80	135	65	40	78	39
M56	355	195	80	135	65	40	78	39

Material: Carbon steel

## MTM 0206 Turnbuckle DIN 1478 Eye and Hook

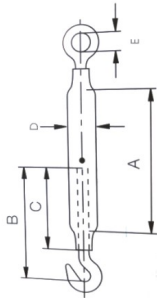

Size	M5	M6	M8	M10	M12	M16	M20	M24	M30	M36
A	70	110	110	125	125	170	200	255	255	295
B	56	77	85	106	117	144	170	215	240	275
C	35	55	57	68	70	88	105	135	135	160
D	14.5	14.5	17.2	21	24.7	29.6	33.3	42	51	63
E	8	9	10	14	16	22	24	38	31	38

Material: Carbon steel

## MTM 0207 Turnbuckle DIN 1478 Eye and Jaw

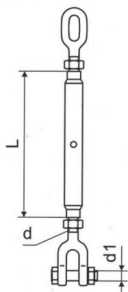
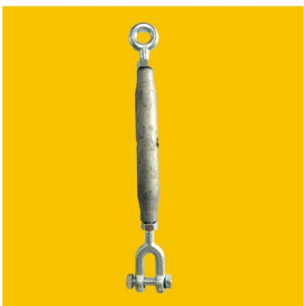

Size (d)	M6	M8	M10	M12	M16	M20	M22	M24
L (mm)	100	108	125	195	230	270	295	325
d1	M5	M6	M8	M10	M12	M16	M20	M22

Material: Carbon steel

## MTM 0208 Turnbuckle DIN 1478 Jaw and Jaw

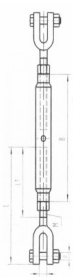
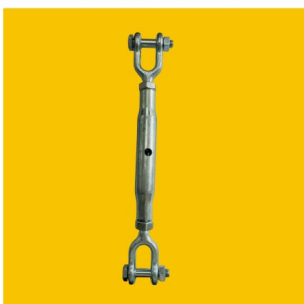

Size	M6	M8	M10	M12	M16	M20	M24	M30	M36
B	110	110	125	125	170	200	255	255	295
L	101	110	125	138	175	213	275	300	385
L1	63	63	75	75	100	120	157	150	180

Material: Carbon steel



### MTM 0209 Turnbuckle DIN1478 Stud End

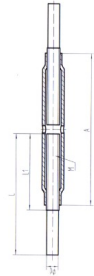

Size	M6	M8	M10	M12	M14	M16	M20	M22
A	110	110	125	125	140	170	200	220
L1	60	65	75	75	90	100	120	120
L	120	120	150	150	165	200	220	220
Size	M24	M27	M30	M36	M42	M48	M56	
A	255	255	255	295	330	355	355	
L1	150	150	160	180	200	220	230	
L	260	265	280	300	350	380	380	

Material: Carbon steel

### MTM 0210 Turnbuckle DIN 1478 Only Body

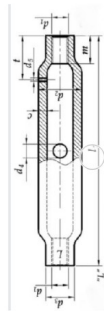

Size(d1)	M6	M8	M10	M12	M16	M20	M24	M30	M36	M42	M48
d2	16	16	20	25	30	34	42	51	63.5	63.5	76
d3 min	9	13.5	15	19	23	27	32	38	48	54	63
d4	6	8	8	10	10	12	12	16	16	16	20
c	2.9	3.6	4	4	4	5	5.5	6	8	8	10
l1	110	110	125	125	170	200	255	255	295	330	355
m	7.5	10	12	15	20	24	29	36	43	51	58
d5	4	4	4	4	4	4	44	4	6	6	6
t	9.5	12	14	17	22	26	31	38	46	54	61

Material: Carbon steel

### MTM 0211 Rigging Screw



WLL (m.t)	Dimensions(mm)									
	Dia Screw A	Length of Body B	Dia of Body C	D				E		
				Jaw				Oval Eye		
				Dia	Dia Pin	Length		Dia	Inside	
D1	D2	D3	D4	E1	E2	E3				
0.100	6	102	12	3	5	15	7	6	15	8
0.150	8	110	15	4	6	16	9	7	19	10
0.375	10	152	21	5	8	21	11	8	25	11
0.500	12	175	27	6	10	25	13	11	30	14
0.750	16	229	27	10	12	40	18	14	41	16
1.125	20	229	33	12	16	45	20	16	51	22
1.600	22	305	33	15	18	48	24	16	51	22
2.000	24	325	42	16	22	65	28	19	57	25
2.750	28	356	48	18	22	59	30	19	57	28
3.750	33	381	48	20	27	62	34	22	65	35
4.250	35	381	60	22	28	68	38	22	65	36
5.000	39	406	60	24	33	74	42	25	74	38

Material: Carbon steel

## MTM 0212 Commercial Type Turnbuckle

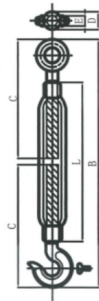

Size (mm)	WLL (kg)	Diemensions(mm)						Weight (lbs)
		B	C	D	E	F	L	
6x100	100	145	215	12	10	6	100	0.35
8x125	200	185	280	14	12	8	125	0.53
10x150	300	210	325	16	14	9	150	0.79
12x200	500	275	430	19	18	11	200	1.41
16x250	1000	345	540	23	24	14	250	3.18
20x300	1500	435	670	28	26	18	300	4.96
22x330	2200	480	740	34	32	20	330	7.79
24x350	3000	555	830	36	36	21	350	9.58

Material: Carbon steel

## MTM 0213 Jis Frame Type Turnbuckle

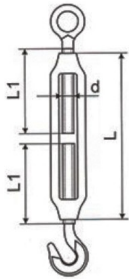

Size (d)	M6	M8	M9	M12	M16	M19	M22	M25	M32
L (mm)	100	125	150	200	250	300	325	350	400
L1 (mm)	47	58	70	93	120	130	155	165	185

Material: Carbon steel



### MTM 0301 DIN 741 Wire Rope Clip

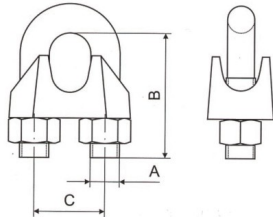

Size (mm)	2	3	4	5	6	8	10	11	13	14
B	15	16	18.5	19	23	28	34	36	45	47
C	6.6	9	9	11	13	16	19	20	24	25
A	M3	M4	M4	M5	M5	M6	M8	M8	M10	M10
Size (mm)	16	19	22	26	30	34	40	45	50	
B	51	63	71	81	94	104	124	148	152	
C	29	32	37	41	48	52	58	65	74	
A	M12	M12	M14	M14	M16	M16	M16	M18	M20	

Material: Carbon steel

### MTM 0302 U.S. Type Drop Forged Wire Rope Clip

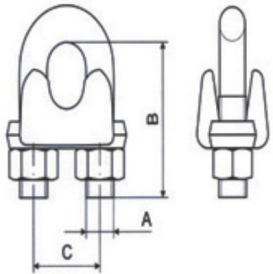

Size (in)	1/8"	3/16"	1/4"	5/16"	3/8"	7/16"	1/2"	9/16"	5/8"	3/4"	7/8"
B	0.72	0.97	1.03	1.38	1.50	1.88	1.88	2.25	2.38	2.75	3.12
C	0.47	0.59	0.75	0.88	1.00	1.19	1.19	1.31	1.31	1.50	1.75
A	0.22	0.25	0.31	0.36	0.44	0.50	0.50	0.56	0.56	0.62	0.75
Size (in)	1"	1-1/8"	1-1/4"	1-3/8"	1-1/2"	1-5/8"	1-3/4"	2"	2-1/4"	2-1/2"	
B	3.50	3.88	4.25	4.63	4.94	5.31	5.75	6.44	7.13	7.69	
C	1.88	2.00	2.31	2.38	2.59	2.75	3.06	3.38	3.88	4.13	
A	0.75	0.75	0.88	0.88	0.88	1.00	1.13	1.25	1.25	1.25	

Material: Carbon steel

### MTM 0303 Malleable Wire Rope Clip Type A

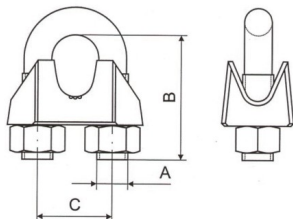

Size (mm)	6	8	10	12	15	20	22
B	24	30	37	47	56	70	77
C	12	15	19	24	29	36	40
A	5	6	8	10	12	14	16
Size (mm)	25	28	32	40	45	50	
B	85	95	108	120	137	154	
C	43	48	55	64	72	80	
A	18	20	22	24	27	30	

Material: Body: Malleable Iron  
U bolt: C15



## MTM 0304 Malleable Wire Rope Clip Type B

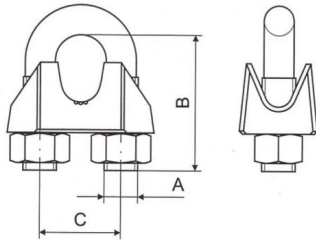

Size (in)	1/8"	3/16"	1/4"	5/16"	3/8"	1/2"	5/8"	1-1/16"	3/4"	7/8"	1"
B (mm)	20	26	26	31	37	46	57	64	71	77	88
C (mm)	9	11	12.5	15.5	21	25	30	33	38.5	40	45
A (mm)	4	5	5	6	8	10	12	12	16	16	20

Material: Body: Malleabel Iron  
U bolt: C15

## MTM 0305 U.S. Type Malleable Wire Rope Clip

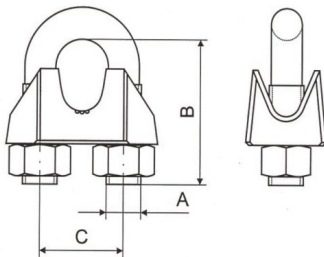

Size (in)	1/16"	1/8"	3/16"	1/4"	5/16"	3/8"	7/16"
B (in)	0.65	0.81	0.94	1.19	1.31	1.63	2.00
C (in)	0.38	0.50	0.56	0.75	0.75	0.88	1.06
A (in)	0.15	0.18	0.25	0.31	0.31	0.38	0.44
Size (in)	1/2"	9/16"	5/8"	3/4"	7/8"	1"	1-1/8"
B (in)	2.00	2.31	2.31	2.56	3.06	3.44	4.00
C (in)	1.06	1.25	1.25	1.31	1.63	1.88	2.00
A (in)	0.44	0.50	0.50	0.56	0.63	0.83	0.75

Material: Body: Malleabel Iron  
U bolt: C15

## MTM 0306 DIN 1142 Wire Rope Clip

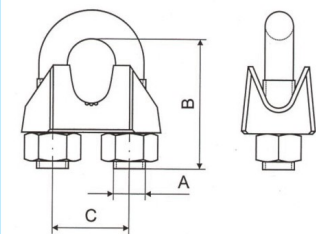

Size (mm)	5	6.5	8	10	13	16	19	22
B	25	32	41	46	64	76	83	96
C	12	14	18	20	27	32	36	40
A	5	6	8	8	12	14	14	16

Material: Carbon steel

## MTM 0307 U.S. Type Drop Forged Fist Grip Clip

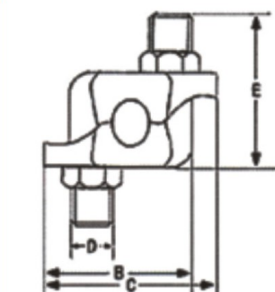

Size (mm)	3/16"-1/4"	5/16"	3/8"	7/16"	1/2"	9/16"	5/8"
A	6.35	7.78	9.65	12.70	12.70	16.00	16.00
B	31.75	34.04	40.39	47.75	47.75	57.90	57.90
C	37.30	39.69	47.63	55.56	55.56	66.68	66.68
D	9.65	9.65	11.18	12.70	12.70	16.00	16.00
E	32.50	37.34	45.97	55.56	55.56	68.33	68.33
Size (mm)	3/4"	7/8"	1"	1-1/8"	1-1/4"	1-3/8"	1-1/2"
A	19.05	22.35	25.40	28.70	31.75	38.10	38.10
B	68.33	75.44	78.23	87.38	90.42	104.90	104.90
C	77.79	79.38	89.69	99.22	102.30	118.27	118.27
D	19.05	19.05	19.05	22.35	22.35	25.40	25.40
E	74.68	84.07	94.50	106.17	107.95	141.22	141.22



### MTM 0308 Deka Wire Rope Clip

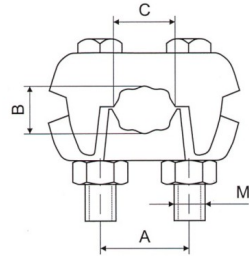

Size (mm)	6	8	10	12	16	20	25
B	17	20	20	21.5	25.5	34	43
C	5	7	9	10	13	17	20
A	6	8	10	12	15	20	25
M	M6	M6	M8	M10	M12	M14	M16

Material: Body: Malleabel Iron  
Bolt Grade: 8.8

### MTM 0309 Simplex Wire Rope Clip

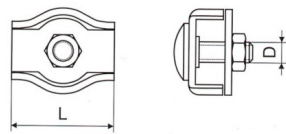
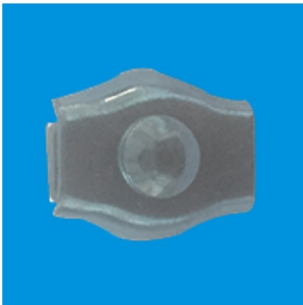

Size (mm)	2	3	4	5	6	8	10
L	15	17	20	25	30	38	42
D	M4	M4	M6	M6	M6	M8	M10

Material: Carbon steel

### MTM 0310 Duplex Wire Rope Clip

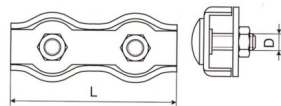

Size (mm)	2	3	4	5	6	8	10
L	30	35	40	50	60	72	84.5
D	M4	M4	M5	M5	M6	M8	M10

Material: Carbon steel

### MTM 0311 Egg Shaped Wire Rope Clip

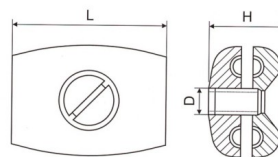

Size (mm)	2	3	4	5	6
L	28	28	34	34	35
H	11	12	14	15	15
D	M5	M5	M6	M6	M6

Material: 1. Aluminum Die Cast  
2. Zinc Die Cast

## MTM 0401 Thimble DIN 6899 Form A

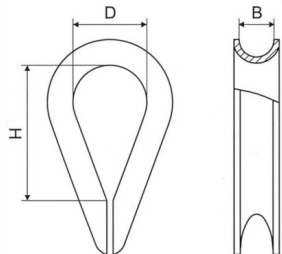

Size (mm)	2.5	3	3.5	4	5	6	7	8	9
B	3	3.5	4	5	6	7	8	9	10
H	21	23	26	28	30	33	35	39	43
D	10	11	12	13	14	15	16	18	20
Size (mm)	10	11	12	13	15	16	18	20	24/26
B	11	12	13	14	16	19	20	22	26
H	47	51	56	61	69	78	86	95	105
D	22	24	26	28	32	35	40	44	48

Material: Carbon steel

## MTM 0402 Thimble DIN 6899 Form B

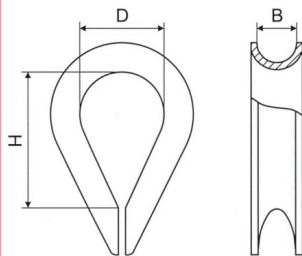

Size (mm)	2.5x3	3.5x4	4x5	5x6	6x7	7x8	9x10	10x12
B	3	4	5	6	7	8	10	12
H	19	21	23	25	28	32	38	45
D	12	13	14	16	18	20	24	28
Size (mm)	12x13	13x14	15x16	16x18	18x20	20x22	22x24	24x26
B	13	14	16	18	20	22	24	26
H	48	51	58	64	72	80	90	99
D	30	32	36	40	45	50	56	62
Size (mm)	26x28	28x30	30x32	32x34	34x36	36x38		
B	28	30	32	34	36	38		
H	112	120	128	152	160	176		
D	70	75	80	95	100	110		

Material: Carbon steel

## MTM 0403 U.S. Type Heavy Duty Thimble G414

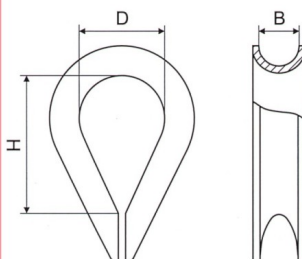

Size (in)	1/4"	5/16"	3/8"	7/16"	1/2"
B	0.28	0.34	0.41	0.47	0.53
H	1.63	1.88	2.13	2.38	2.75
D	0.88	1.06	1.13	1.25	1.50
Size (in)	9/16"	5/8"	3/4"	7/8"	1"
B	0.59	0.66	0.78	0.94	1.06
H	2.75	3.25	3.75	4.25	4.50
D	1.50	1.75	2.00	2.25	2.50
Size (in)	1-1/8"x1-1/4"	1-1/4"x1-3/8"	1-3/8"x1-1/2"	1-5/8"	1-3/4"
B	1.31	1.44	1.56	1.72	1.84
H	5.13	6.25	6.50	8.00	9.00
D	2.88	3.50	3.50	4.00	4.50

Material: Carbon steel



**MTM 0404 U.S. Type Light Duty Thimble G411**

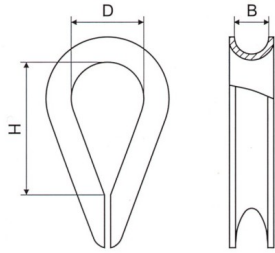

Size (in)	1/8"	3/16"	1/4"	5/16"	3/8"	1/2"
B	0.16	0.22	0.28	0.34	0.41	0.53
H	1.31	1.31	1.31	1.5	1.63	1.88
D	0.69	0.69	0.69	0.81	0.94	1.13
Size (in)	5/8"	3/4"	7/8"	1"	1-1/8"x1-1/4"	
B	0.66	0.78	0.94	1.06	1.31	
H	2.25	2.5	3.5	4.25	4.5	
D	1.36	1.63	1.88	2.5	2.75	

Material: Carbon steel

**MTM 0405 European Type Thimble**

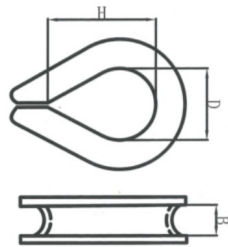

Size (mm)	4	5	6	7	8	10	12	14	16
A	25	31	37	44	51	64	76	82	89
B	20	24	29	34	38	46	57	60	64
C	11	15	18	22	24	30	38	40	42
D	7	8	10	11	12	14	18	20	22
E	4	5	6	7	8	10	12	14	16
Size (mm)	18	20	22	24	26	28	30	32	
A	102	115	127	140	152	165	178	203	
B	69	79	89	102	105	115	121	133	
C	45	51	54	64	64	73	79	93	
D	26	28	30	34	34	38	44	46	
E	18	20	22	26	28	30	32	34	

Material: Carbon steel

## MTM 0501 Eye Bolt DIN580

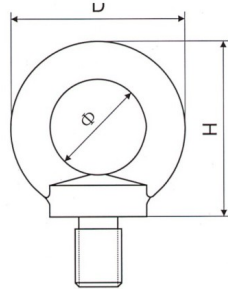

Size	M6	M8	M10	M12	M14	M16	M20	M22	M24	M27
D (mm)	28	36	45	54	63	63	72	81	90	90
Φ (mm)	16	20	25	30	35	35	40	45	50	50
H (mm)	36	36	45	53	62	62	71	80.5	90	90
Size	M30	M33	M36	M39	M42	M45	M48	M52	M56	M64
D (mm)	108	108	126	126	144	144	166	166	184	206
Φ (mm)	60	60	70	70	80	80	90	90	100	110
H (mm)	109	109	128	128	147	168	168	187	187	208

Material: Carbon steel

## MTM 0502 Eye Nut DIN582

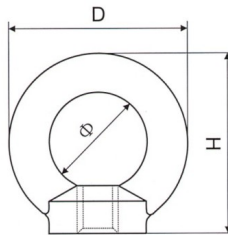

Size	M6	M8	M10	M12	M16	M20	M22
D (mm)	36	36	45	54	63	72	81
Φ (mm)	20	20	25	30	35	40	45
H (mm)	36	36	45	53	62	71	80.5
Size	M24	M27	M30	M33	M36	M39	
D (mm)	90	90	108	108	126	126	
Φ (mm)	50	50	65	65	75	75	
H (mm)	90	97	109	109	128	147	

Material: Carbon steel

## MTM 0503 JIS 1168

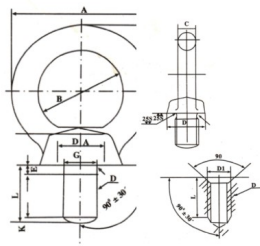

Size	M6	M8	M10	M12	M16	M20	M24	M30	M36	M42	M48	M64
A	24.5	32.6	41	50	60	72	90	110	133	151	170	210
B	14.5	20	25	30	35	40	50	60	70	80	90	110
C	5	6	8	10	12.5	16	20	25	31.5	35.5	40	50
D	13	16	20	25	30	35	45	60	70	80	90	110
T	4	5	7	9	11	13	18	22	25	30	35	42
h	15	17	21	26	30	35	45	55	65	75	85	105
H (reference)	27.2	33.3	41.5	51	60	71	90	110	131.5	150.5	170	210
L	14	15	18	22	27	30	38	45	55	65	70	90
E	3	3	4	5	5	6	8	8	10	12	12	14
G (minimum)	5.2	6	7	9.5	12.5	15	20.5	26	32	37	42	54

Material: Carbon steel



**MTM 0504 JIS 1169**

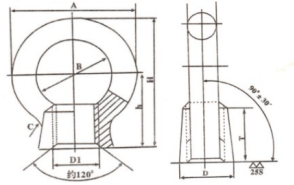

Size	M6	M8	M10	M12	M14	M16	M20	M30	M36	M42	M48	M64	M80
A	23	32.6	41	50	60	72	90	110	133	151	170	210	266
B	14	20	25	30	35	40	50	60	70	80	90	110	140
C	4.5	6.3	8	10	12.5	16	20	25	31.5	35.5	40	50	63
D	7	16	20	25	30	35	45	60	70	80	90	110	130
T	10	12	15	19	23	28	38	46	55	64	73	90	108
h	18	23	28	36	42	50	66	80	95	109	123	151	184
H (reference)	30	39.3	48.5	61	72	86	111	135	161.5	184.5	208	256	317
R (approx)	6	8	10	12	14	16	25	30	35	40	45	50	60
D1	6.5	8.5	10.6	12.5	17	21.2	25	31.5	37.5	45	50	67	85

Material: Carbon steel

**MTM 0505 Eye Screw BS 4278-1 Collared Eye**

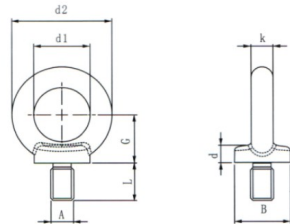

Size	M6	M8	M10	M12	M16	M18	M20	M22	M24
A	6	8	10	12	16	18	20	33	24
B	22	22	22	22	29	36	40	45	52
D	7	7	7	7	10	12	14	15	17
d1	15	15	15	15	20	24	27	30	35
d2	33	33	33	33	44	52	59	64	77
k	9	9	9	9	12	14	16	18	21
G	20	20	20	20	26	32	36	40	46
L	18	18	18	18	23	28	32	35	40

Size	M27	M30	M33	M36	M39	M45	M52	M56	M64
A	27	30	33	36	39	45	52	56	64
B	58	65	72	81	90	101	115	128	144
D	20	22	24	27	30	34	38	43	48
d1	39	44	48	54	60	68	76	86	96
d2	85	96	106	118	123	148	168	188	212
k	23	26	29	32	36	40	46	51	58
G	52	58	64	72	80	90	102	114	128
L	46	51	56	63	70	79	89	100	112

Material: Carbon steel

**MTM 0506 Eye Screw BS 4278L Long Shank Collared Eyebolt**

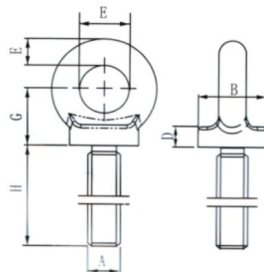

VERTICAL SWL TON	0.25	0.4	0.8	1.6	2.5	2.75
A	10	12	16	20	24	24.5
B	22	28	36	43	57	57
D	7	10	12	14	19	19
E	15	19	24	28	38	38
F	9	11	14	17	22	22
G	20	25	32	38	51	51
H	178	178	178	178	178	178

Material: Carbon steel

## MTM 0507 BS 4278-3 Dynamo Eyebolts

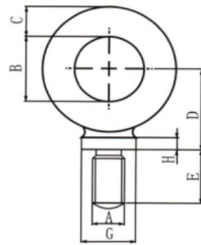

VERTICAL SWL TON	0.10	0.15	0.25	0.32	0.50	0.63	1.00	1.25	1.60	2.00	3.20
A	6	8	10	12	14	16	18	20	22	24	30
B	22	22	22	22	32	29	40	40	44	51	64
D	9	9	9	9	13	11	15	15	17	19	24
E	27	27	27	27	41	34	47	47	53	60	76
F	18	18	18	18	28	23	32	32	35	40	51
G	17	17	17	17	29	23	32	32	35	40	51
H	5	5	5	5	9	6	9	9	14	12	14

Material: Carbon steel

## MTM 0508 BS 4278H Long Shank Dynamo Eyebolt

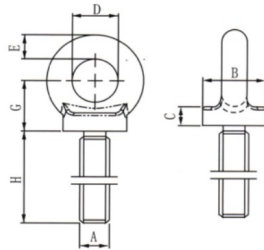

VERTICAL SWL TON	0.16	0.25	0.32	0.63	1.25	2.00
A	8	10	12	16	20	24
B	19	19	25	29	35	41
D	6	6	8	9.5	11	13
E	22	22	29	32	41	51
F	9.5	9.5	11	13	16	19
G	27	27	35	41	54	64
H	100	100	100	114	127	127

Material: Carbon steel

## MTM 0509 BS 3974 Bow Nut

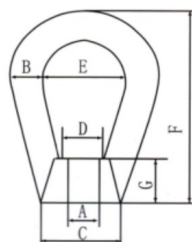
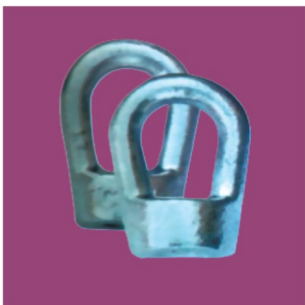

VERTICAL SWL TON	0.23	0.36	0.53	0.53	0.53	0.53	0.53	0.53
A	8	10	12	16	20	24	30	36
B	10	10	12	12	14	17	26	26
D	32	32	38	38	45	50	70	70
E	16	16	18	18	25	28	38	38
F	25	25	30	30	40	50	75	75
G	64	64	73	73	102	124	149	149
H	16	16	17	17	25	29	29	29

Material: Carbon steel





### MTM 0510 European Type Swivel With Eye and Jaw

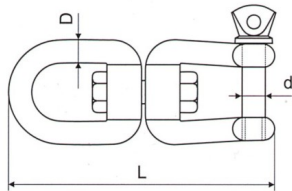

Size (mm)	6	8	10	13	16	19
D	6	8	10	13	16	19
d	6	8	10	13	16	19
L	66	94	118	152	188	229

Material: Carbon steel

### MTM 0511 European Type Swivel With Eye and Eye

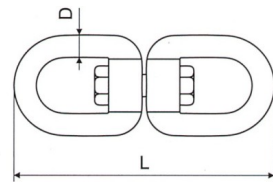

Size (mm)	6	8	10	13	16	19
D	6	8	10	13	16	19
L	65	90	115	154	188	229

Material: Carbon steel

### MTM 0512 European Type Swivel With Jaw and Jaw

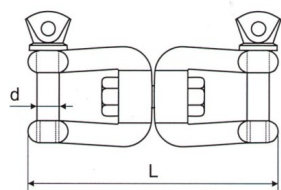

Size (mm)	6	8	10	13	16	19
D	6	8	10	13	16	19
L	66	94	118	152	188	229

Material: Carbon steel

### MTM 0513 Chain Swivel G-401

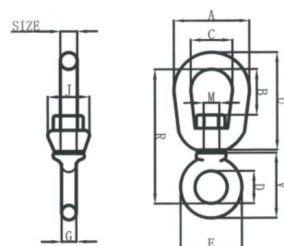
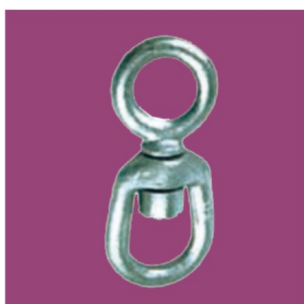

Size (in)	Dimensions (in)										
	A	B	C	D	E	G	J	M	R	U	V
1/4"	1.25	0.69	0.75	0.62	1.12	0.25	0.69	0.31	2.25	1.69	1.25
5/16"	1.63	0.81	1.00	0.75	1.38	0.31	0.81	0.38	2.72	2.06	1.47
3/8"	2	0.94	1.25	1.00	1.75	0.38	1.00	0.5	3.44	2.5	1.88
1/2"	2.5	1.31	1.50	1.25	2.25	0.50	1.31	0.63	4.25	3.19	2.44
5/8"	3	1.56	1.75	1.50	2.75	0.62	1.50	0.75	5.13	3.88	2.94
3/4"	3.5	1.75	2.00	1.75	3.25	0.75	1.88	0.88	5.78	4.94	3.46

Material: Carbon steel

## MTM 0514 Regular Swivel G-402

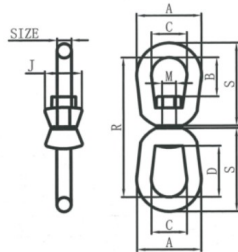

Size (in)	WLL(lbs)	Dimensions(in)							
		A	B	C	D	J	M	R	S
1/4"	850	1.25	0.69	0.75	1.06	0.69	0.31	2.94	1.69
5/16"	1250	1.63	0.81	1.00	1.25	0.81	0.38	3.56	2.06
3/8"	2250	2	0.94	1.25	1.50	1.00	0.50	4.31	2.5
1/2"	3600	2.5	1.31	1.50	2.00	1.31	0.63	5.44	3.19
5/8"	5200	3	1.56	1.75	2.38	1.50	0.75	6.56	3.88
3/4"	7200	3.5	1.75	2.00	2.63	1.88	0.88	7.19	4.31
7/8"	10000	4	2.06	2.25	3.06	2.13	1	8.38	5
1"	12500	4.5	2.31	2.5	3.5	2.38	1.13	9.63	5.75
1-1/4"	18000	5.63	2.69	3.13	3.69	3	1.5	11.44	6.75
1-1/2"	45200	7.09	3.88	4.09	3.88	3.75	2.25	16.69	9.91

Material:Carbon steel

## MTM 0515 Jaw End Swivel G-403

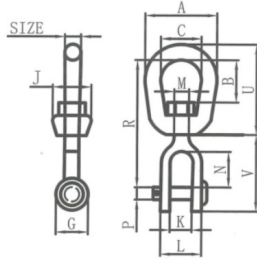

Size (in)	Dimensions(in)												
	A	B	C	G	J	K	L	M	N	P	R	U	V
1/4"	1.25	0.69	0.75	0.69	0.69	0.47	1.03	0.31	0.88	0.25	2.63	1.69	1.69
5/16"	1.63	0.81	1.00	0.81	0.81	0.50	1.13	0.38	0.88	0.31	2.94	2.06	1.81
3/8"	2	0.94	1.25	1.00	1.00	0.63	1.41	0.5	1.06	0.38	3.63	2.5	2.25
1/2"	2.5	1.31	1.50	1.31	1.31	0.75	1.75	0.63	1.31	0.5	4.5	3.19	2.88
5/8"	3	1.56	1.75	1.63	1.50	0.94	2.06	0.75	1.5	0.63	5.31	3.88	3.44
3/4"	3.5	1.75	2.00	1.88	1.88	1.13	2.53	0.88	1.75	0.75	6.06	4.31	4
7/8"	4	2.06	2.25	2.13	2.13	1.19	2.75	1	2.06	0.88	7	5	4.53
1"	4.5	2.31	2.5	2.63	2.38	1.75	3.72	1.13	2.81	1.13	8.56	5.75	5.94
1-1/4"	5.69	2.69	3.13	3.13	3	2.06	4.31	1.63	2.81	1.38	9.75	7.06	6.38
1-1/2"	7	3.88	4	5.63	4	2.88	6	2.25	4.44	2.25	14.25	10	10.84

Material:Carbon steel

## MTM 0516 Round Swivel with Ring

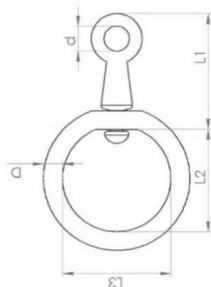
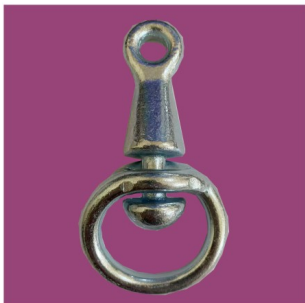

Size (mm)	4	5	6	7	8	9	10
L1	49	49	49	68	68	68	68
L2	26	26	30	30	35	35	35
L3	30	30	35	35	45	45	45
d	6.1	6.1	6.1	8.8	8.8	8.8	8.8

Material:Carbon steel





### MTM 0601 Snap Hook DIN5299 Form A (With Thimble)

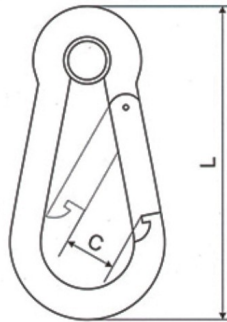

Size (mm)	4	5	6	7	8	9	10	11	12	13	14	15
L	40	50	60	70	80	90	100	120	140	160	180	200
C	7	7	8	8	9	10	11	16	19	25	35	35

Material: Carbon steel

### MTM 0602 Snap Hook DIN5299 Form B (Straight Type)

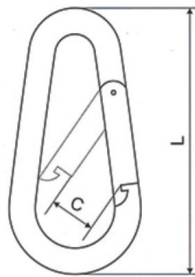

Size (mm)	4	5	6	7	8	9	10	11	12	13	14	15
L	40	50	60	70	80	90	100	120	140	160	180	200
C	7	7	8	8	9	10	11	16	19	25	35	35

Material: Carbon steel

### MTM 0603 Snap Hook DIN5299 Form C

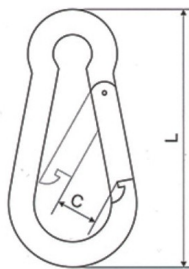

Size (mm)	4	5	6	7	8	9	10	11	12	13	14	15
L	40	50	60	70	80	90	100	120	140	160	180	200
C	7	7	8	8	9	10	11	16	19	25	35	35

Material: Carbon steel

### MTM 0604 Snap Hook DIN5299 Form D



Size (mm)	4	5	6	7	8	9	10	11	12	13	14	15
L	40	50	60	70	80	90	100	120	140	160	180	200
C	7	7	8	8	9	10	11	16	19	25	35	35

Material: Carbon steel

## MTM 0605 Quick Link

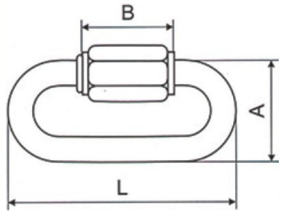

Size (mm)	3.5	4	5	6	7	8	9	10	12	14	16
L	36.5	39.5	48	57	66	76	83	89	107	121	140
A	17	19	23	26	30	34	37	40	49	54	61
B	11.5	12.5	15	19	21	23	26	29	32	39	43

Material: Carbon steel

## MTM 0606 S Hook

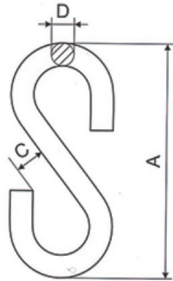

Size (mm)	3	4	5	6	7	8	10	12
D	3	4	5	6	7	8	10	12
A	25	35	45	55	65	75	105	120
C	3	4.5	6.5	7	8	10	11	13.5

Material: Carbon steel

## MTM 0607 Swivel Snap Hook

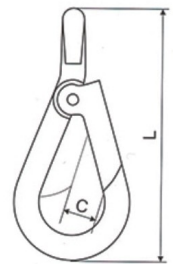

Size (in) mm	2(5)	2-1/2"(6)	3(7)	3-1/2"(8)	4(10)
d	5.5	6.3	7	8	9.4
C	6	7	7	9	11
φ	15.5	15.5	20	21.5	24

Material: Carbon steel

## MTM 0608 Security Snap Hook

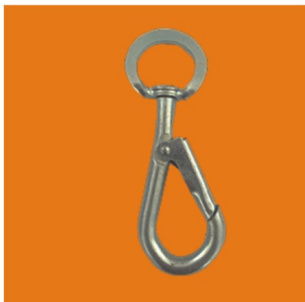

Size (mm)	5	6	7	8	9	10
L	50	63	70	80	91	106
C	5.5	6.5	7.5	10.5	11	14.5

Material: Carbon steel



### MTM 0609 Key Snap Hook(Zinc-Die-Cast)

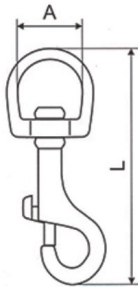

Size	1#	2#	3#
A	21	26	32
L	105	110	112

Material: Zinc Die Cast

### MTM 0610 Eye Hook With Latch DIN 689

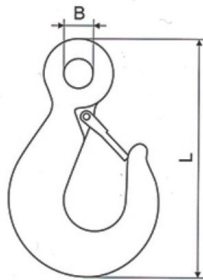

Size (kgs)	250	500	1,000	1,600	2,500
B	12	16	20	26	32
L	89	118	160	190	240

Material: Carbon steel

### MTM 0611 Eye Hook With Latch S320C, S320A

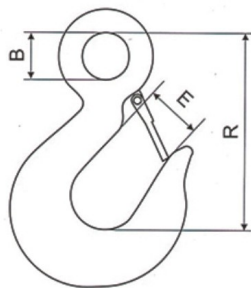

WLL(t)		Dimensions(in)			Weight (lbs)
320C	320A	B	R	E	
1/2"	3/4	0.63	2.80	0.81	0.37
3/4"	1	0.75	3.22	0.88	0.57
1"	1 1/2	0.91	3.66	0.97	0.77
1-1/2"	2	1.12	4.09	1.00	1.28
2"	3	1.25	4.69	1.12	1.73
3"	4 1/2	1.56	5.78	1.34	3.66
5"	7	2.00	7.38	1.69	7.19
7-1/2"	11	2.44	9.06	2.06	13.17
10	15	2.83	10.09	2.22	22.15

Material: 320C Carbon Steel, 320A Alloy Steel

### MTM 0612 Swivel Hook S-322

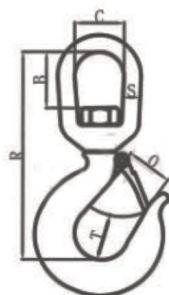
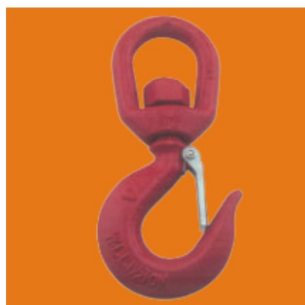

WLL(t)		Dimensions(in)						Weight (lbs)
322C	322A	B	C	O	R	S	T	
3/4"	1	0.93	1.25	0.88	4.47	0.37	0.80	0.77
1"	1 1/2	1.31	1.50	0.97	5.28	0.50	0.80	1.27
1-1/2"	2	1.62	1.75	1.00	6.00	0.62	0.84	2.28
2"	3	1.56	1.75	1.125	6.37	0.62	1.19	2.60
3"	4 1/2	1.75	2.00	1.34	7.40	0.75	1.37	4.81
5"	7	2.31	2.50	1.69	9.59.00	1.00	1.78	10.40
7-1/2"	11	2.38	2.75	2.06	11.12	1.125	2.125	16.420
10"	15	2.80	3.12	2.25	11.93	1.25	2.50	23.40

Material: 322C Carbon Steel, 322A Alloy Steel

## MTM 0613 Clevis Grab Hook H-330, A-330

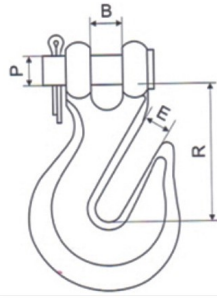

Size (in)	WLL(lbs)		Dimensions(in)				Weight (lbs)
	H-330	A-330	B	E	P	R	
1/4"	2600	3600	0.36	0.40	0.38	1.97	0.40
5/16"	3900	5400	0.40	0.44	0.44	2.26	0.79
3/8"	5400	7500	0.48	0.50	0.47	2.63	1.00
7/16"	7200	10000	0.66	0.56	0.56	2.75	1.50
1/2"	9200	12750	0.75	0.66	0.63	3.19	2.10
5/8"	12750	19000	0.91	0.78	0.75	4.09	4.20
3/4"	18500	27000	0.94	0.94	0.88	4.63	6.50

Material: H-330 Carbon Steel, A-330 Alloy Steel

## MTM 0614 Clevis Slip Hook H-331, A-331

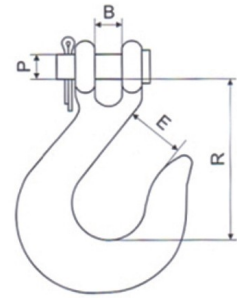
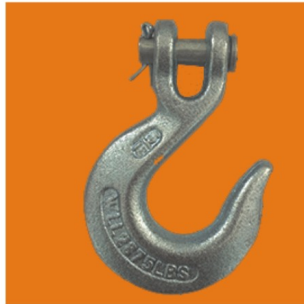

Size (in)	WLL(lbs)		Dimensions(in)				Weight (lbs)
	H-331	A-331	B	E	P	R	
1/4"	1950	2750	0.44	0.94	0.38	2.56	0.50
5/16"	2875	4300	0.50	1.66	0.44	2.87	0.75
3/8"	4000	5250	0.59	1.31	0.47	3.25	1.20
7/16"	5000	7000	0.66	1.56	0.56	3.70	2.06
1/2"	6500	9000	0.75	1.69	0.63	4.00	2.80
5/8"	9250	13500	0.91	2.00	0.75	4.94	4.75
3/4"	12500	19250	1.31	2.50	1.00	6.09	10.30

Material: H-331 Carbon Steel, A-331 Alloy Steel

## MTM 0615 Eye Grab Hook H-323, A-323

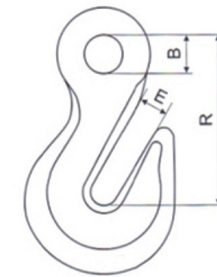

Size (in)	WLL(lbs)		Dimensions(in)			Weight (lbs)
	H-323	A-323	B	E	R	
1/4"	2600	3600	0.50	0.34	1.97	0.28
5/16"	3900	5400	0.56	0.44	2.25	0.45
3/8"	5400	7500	0.66	0.50	2.56	0.79
7/16"	7200	10000	0.75	0.56	2.94	1.19
1/2"	9200	12750	0.88	0.66	3.38	1.80
5/8"	12750	19000	1.06	0.78	4.11	3.30
3/4"	18500	27000	1.38	0.94	5.16	6.00

Material: H-323 Carbon Steel, A-323 Alloy Steel

## MTM 0616 Eye Slip Hook H-324, A-324

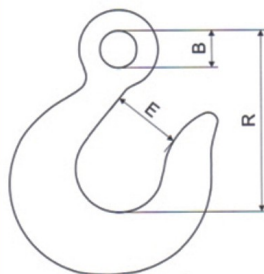

Size (in)	WLL(lbs)		Dimensions(in)			Weight (lbs)
	H-324	A-324	B	E	R	
1/4"	1950	2750	0.50	0.94	2.56	0.40
5/16"	2875	4300	0.63	1.06	2.95	0.70
3/8"	4000	5250	0.72	1.31	3.36	1.00
7/16"	5000	7000	0.81	1.56	3.88	1.60
1/2"	6500	9000	0.94	1.69	4.28	2.40
5/8"	9250	13500	1.13	2.00	5.22	4.00
3/4"	12500	19250	1.38	2.13	5.80	6.50

Material: H-324 Carbon Steel, A-324 Alloy Steel



### MTM 0617 Drop Forged Hook

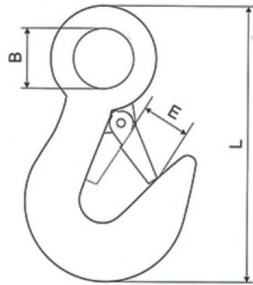

L (mm)	95	100
B (mm)	17	22
E (mm)	14	14

Material: Carbon steel

### MTM 0618 G80 European Type Connecting Link

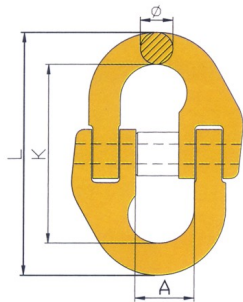
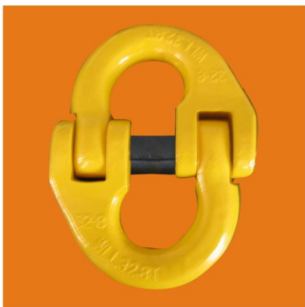

WEIGHT/KG	WLL/T	B.L/T	A	L	K	φ
0.14	1.2	4.8	16.2	58	42	7
0.2	2	8	20.5	75	57	8.5
0.38	3.2	12.8	28	89	68	10.8
0.76	5.4	21.6	30	116	83	15
1.1	8.2	32.8	36.3	144	105	19.8
1.8	12.8	50	44	170	120	24
3.2	16	64	51	192	137	26
4.5	20.6	88	58	220	157	30
9	31.5	126	67.5	281	201	37

### MTM 0619 U.S. Type Connecting Link

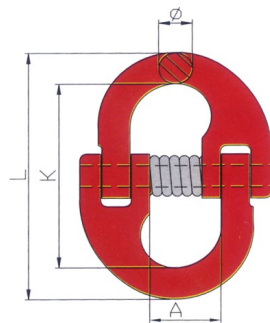
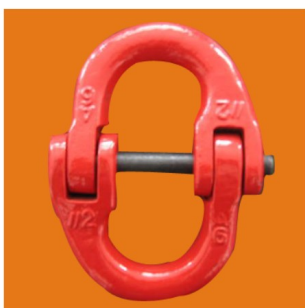

WEIGHT/KG	WLL/lbs	B.L/T	A	L	K	φ
0.25	3250	12000	16.8	66.5	47.5	9.5
0.61	6600	26400	22	90	64	13
1.25	11250	45000	29.2	120	86	17
2.31	16500	66000	35.5	142	103	19.5
4.01	23000	92000	41	161	115	23
5.75	28750	11500	51	191	135	28

### MTM 0620 G80 U.S. Type Connecting Link

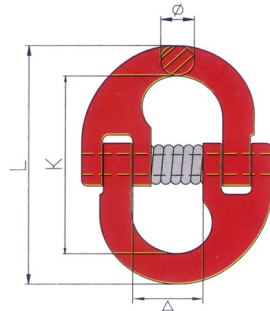
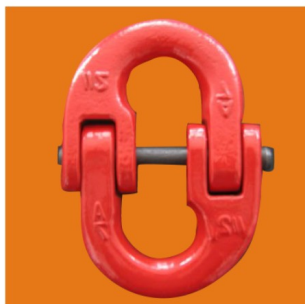

WEIGHT/KG	WLL/lbs	B.L/T	A	L	K	φ
0.29	3500	14000	21	65	51	7
0.56	7100	28400	28.8	88	71	11.5
1.06	12000	48000	36.8	112	82	15
2.43	18100	72400	45.2	136	94	21
4.23	28300	113200	48.8	170	125	22.5
6.81	34200	136800	53.8	192	142	24.5



## MTM 0621 G80 Special Connecting Link B Type

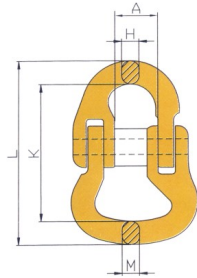
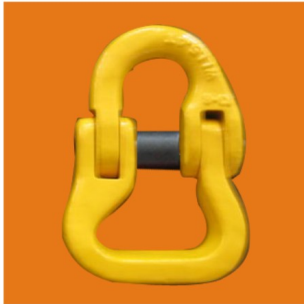

WEIGHT/KG	WLL/T	B.L/T	A	M	H	K	L
2.8	12.5	50	43.5	26.2	20	182	242
4.3	15.25	61	52.5	28.2	25	200	268
5.6	20	80	58.2	33	30	226	301

## MTM 0622 G80 European Type Eye Self-Locking Hook

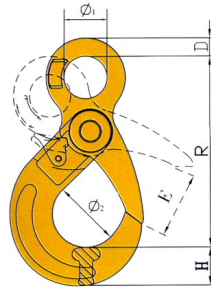

WEIGHT/KG	WLL/T	B.L/T	Φ1	R	D	Φ2	H	E
0.5	1.2	4.8	22	110	10.5	35	22	28
0.8	2.0	8.0	25	134	12	46	24	34
1.5	3.2	12.8	32	170	15	55	28	45
3.2	5.4	21.6	40.5	206	20	69	40	54
6.1	8.2	32.8	56	249	22	84	51	63
7.5	12.5	50	64.5	273	27	100	56	81
13.4	15	60	70	320	30	99	67	82
18.5	21.2	82.8	80	362	34	110	75.5	114.5
44.5	31.5	126	105	472	45	147	96	168

## MTM 0623 G80 European Type Swivel Eye Self-Locking Hook

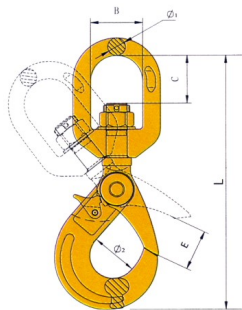
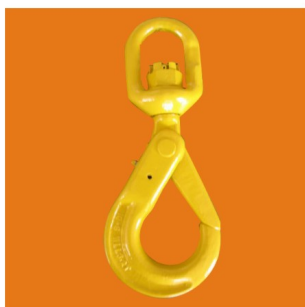

WEIGHT/KG	WLL/T	B.L/T	B	C	Φ1	L	Φ2	E
0.71	1.2	4.8	33	23	11.25	150	28	28
1.3	2.0	8.0	34	27	12	185	34	32
2.2	3.2	12.8	42	35	15	216	45	46
4.5	5.4	21.6	48	41	16	268	54	56
8.2	8.2	32.8	61	54	21.5	330	62	62
11.7	12.5	50	70	64	26	355	70	78
16	15	60	97	95	33	457	80	84
21.5	21.2	82.8	123	115	42	535	98	106

## MTM 0624 G80 U.S. Type Eye Self-Locking Hook

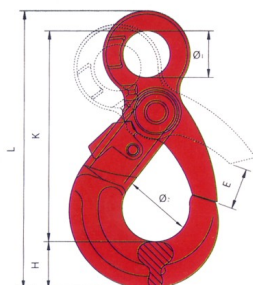
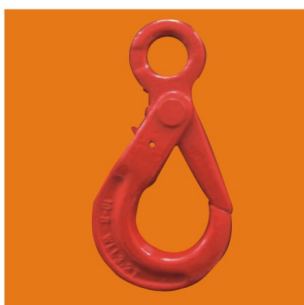

WEIGHT/KG	WLL/T	B.L/T	Φ1	E	Φ2	H	K	L
0.94	2	8	25	35	42	27.5	133	170.5
1.83	3.2	12.8	32.5	46	55	29.5	168.5	212.5
3.3	5.4	21.6	42	56	64	42.5	211	270.5



### MTM 0625 G80 Clevis Eye Self-Locking Hook With Grip

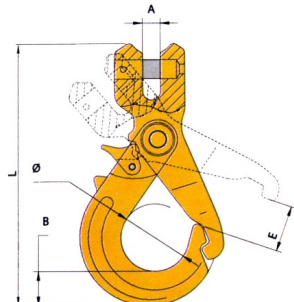

WEIGHT/KG	WLL/T	B.L/T	A	B	E	L	Φ
0.85	2	8	9	21.5	37	178	40
1.4	3.2	12.8	10	26	46	190	50
2.5	5.4	21.6	15	31	54	231	60
5.6	8.2	32.8	18	40	65	272	70

### MTM 0626 G80 Eye Foundry Hook

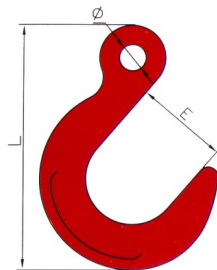

WEIGHT/lbs	WLL/lbs	B.L/lbs	E	Φ	L
2.4	3500	14000	63.5	16	163
4.5	7100	28400	76	19	200
7.1	1200	48000	89	25.4	238
12.2	18100	72400	102	32	278
19.3	28300	113200	114.5	38	325
26.3	34200	136800	127.5	40	361

### MTM 0627 G80 Eye Hoist Hook With Latch

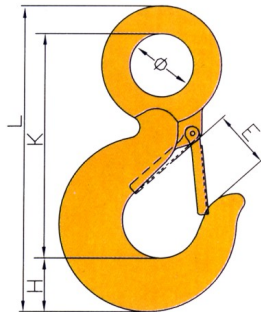

WEIGHT/KG	WLL/T	B.L/T	Φ	E	H	K	L
0.25	1	4	19	22	19	80	110
0.5	2	8	28	25	25	103	140.5
0.77	3	12	31	27.5	28	118	162
1.52	4.5	18	39	33	35	145	201
3.27	7	28	51	40	45	180	256
6.8	11	44	62	51	57	230	317
9.96	15	60	73	57	70	260	360
15.33	22	88	89	75	76	318	434
18	30	120	90	82	91	360	495.5

### MTM 0628 G80 Eye Sling Hook With Forged Latch

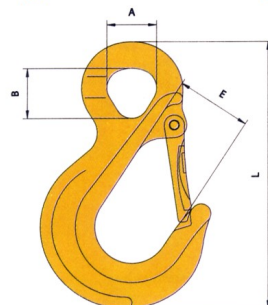
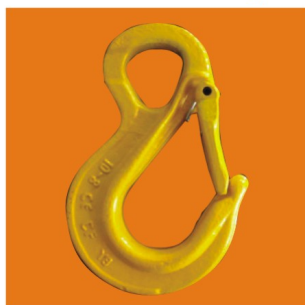

WEIGHT/KG	WLL/T	B.L/T	A	B	E	L
0.52	2	8	25.5	26	38.3	138.5
0.86	3.2	12.8	35	37.5	42	163.7
1.69	5.4	21.6	40.5	41.5	52	210

## MTM 0629 G80 Weld on Hook Regular Type

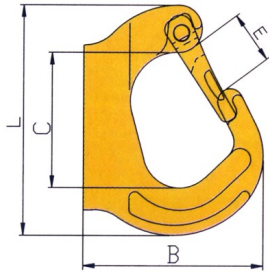

WEIGHT/KG	WLL/T	B.L/T	E	B	C	L
0.83	2	10	26.5	92	67	114
1.18	3	15	30.5	106	73.5	129
2.5	5	25	34.5	136	94	171
3.26	8	40	34.5	140	94	177
5.17	10	50	51	171.5	134.5	223

## MTM 0630 G80 Clevis "C" Hook

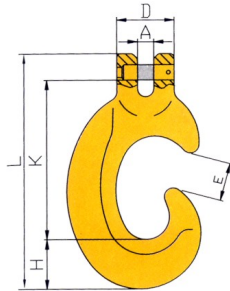

WEIGHT/KG	WLL/T	B.L/T	A	E	D	H	K	L
0.57	2	8	9.5	20	35	28	90	136
1.4	3.2	12.8	13	29.5	46	39	127	198
3.0	5.4	21.6	16.5	39.5	59	52	166.5	246
5.4	8.2	32.8	18.5	46.5	72	59	206	298

## MTM 0631 G80 Eye Choke Hook

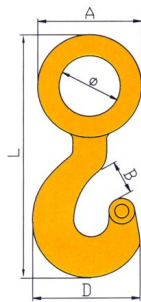
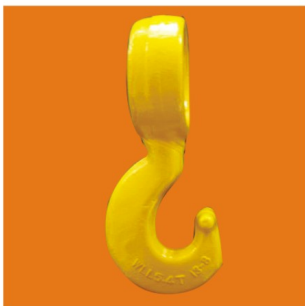

WEIGHT/KG	WLL/T	B.L/T	A	B	φ	D	L
0.36	2	8	52	16	30.5	53.5	123
0.73	3.2	12.8	68	20	39	67.5	156
1.4	5.4	21.6	85	27	52	83	195
3.18	8.2	32.8	108	30	64	165	246

## MTM 0632 G80 Clevis Chain Clutch

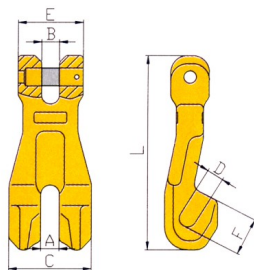

WEIGHT/KG	WLL/T	B.L/T	A	B	C	D	E	F	L
0.21	1.2	4.8	7.5	7.5	33	7.5	26	12	73.5
0.4	2	8.0	9.5	9.5	45	10.5	36	17	101
0.94	3.2	12.8	13	13	55	12.4	48	28	138
1.75	5.4	21.6	18	16	75	15.5	59	34.5	177
3.16	8.2	32	21	21	93	19.5	73	40	220
6.2	12.5	50	22	22	99	22.5	78	46	238
8.5	15	60	25.5	25.5	118	25.5	98	57.5	295



**MTM 0633 Large Opening Eye Hook**

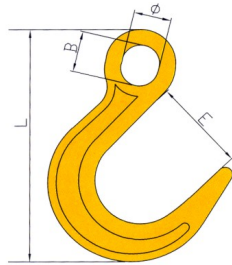

WEIGHT/KG	WLL/T	B.L/T	ϕ	B	E	L
0.84	3.2	6.4	31	36	60	173.5
1.17	3.8	7.6	31	36	79	199

**MTM 0634 G80 Sling Hook With Connecting Link**

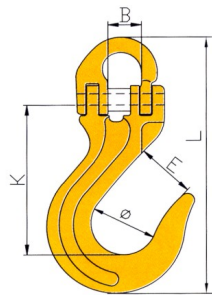
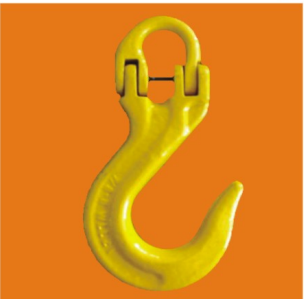

WEIGHT/KG	WLL/T	B.L/T	E	B	ϕ	K	L
0.47	2	8	32.5	28.5	37	87	149

**MTM 0635 Special Shank Hook**

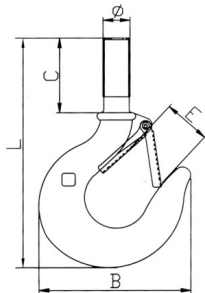

WLL/KG	ϕ	B	C	E	L
250	12	65	29	16	105
500	14	69	30	15	105
1000	16	80	33	20	122
2000	20	98	42	24	153

**MTM 0636 Forged Alloy Steel Sorting Hook**

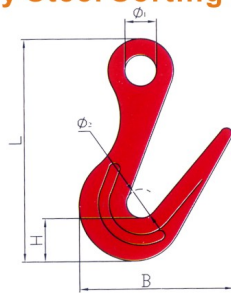

D.L(Inch)	LD,DFEYE (Inch)	N.W(lbs)	ϕ <sub>1</sub>	B	ϕ <sub>2</sub>	L	H
9.69	1.38	6.25	35	170	33	254	28

**MTM 0637 Swivel Hoist Hook With Latch**

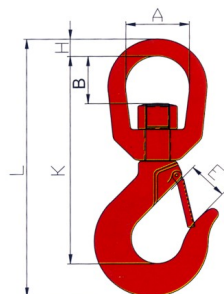
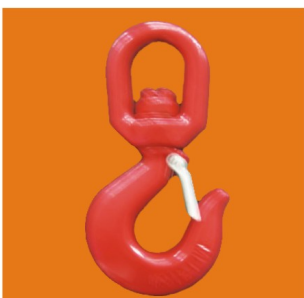

WEIGHT/KG	WLL/T		A	B	E	H	K	L
	CARBON	ALLOY						
0.38	1	1.5	38	33	23	12.7	134	168
1.0	1.5	2	43	39	24	15.8	150	190
1.2	2	3	43	40	28	15.8	162	206
2.08	3	4.5	51	45	27	18	190	242
4.45	5	7	64	56	36.5	21.5	240	309
7.4	7.5	11	69	54	44	28	175	350
10.6	11	15	78	50	48	32	324	415



## MTM 0701 DIN763 Long Link Chain

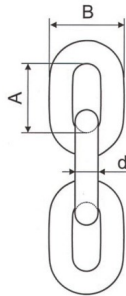

Size(d) mm	2	3	4	5	6	8	9	10	11	12
A	26	32	35	42	49	52	59	65	72	78
B	12	16	20	24	28	32	36	40	44	48
Working Load (kg)	25	55	100	160	200	400	530	630	790	940
Weight Per M (kg)	0.06	0.15	0.27	0.43	0.63	1.10	1.41	1.75	2.11	2.55
Size(d) mm	13	16	18	19	20	22	25	28	32	
A	82	100	113	119	120	127	140	152	171	
B	52	64	70	72	75	82	85	96	108	
Working Load (kg)	1000	1600	2120	2370	2500	3170	4090	6000	8000	
Weight Per M (kg)	2.95	4.45	5.65	6.25	7.00	8.55	10.90	13.90	18.20	

Material:Carbon steel

## MTM 0702 DIN766 Short Link Chain

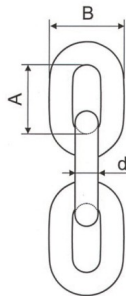

Size(d) mm	2	3	4	5	6	7	8	9	10	11	12	13
A	12	16	16	18.5	18.5	22	24	27	28	31	36	36
B	7.5	11	13.7	17	20.2	23.8	27.2	30.6	34	37.4	40.8	44.2
Weight Per M (kg)	0.07	0.16	0.32	0.50	0.80	1.10	1.40	1.80	2.20	2.70	3.10	3.80
Size(d) mm	14	16	18	19	20	22	23	26	28	30	32	
A	41	45	50	53	56	62	64	73	78	84	90	
B	47.60	54.40	61.20	64.60	68.00	75.00	78.20	88.40	95.20	102.00	108.80	
Weight Per M (kg)	4.40	5.70	7.30	7.97	9.00	11.00	12.00	15.00	18.00	19.50	23.00	

Material:Carbon steel

## MTM 0703 Link Chain DIN5685A/C

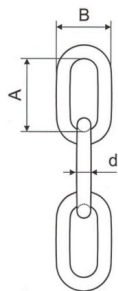
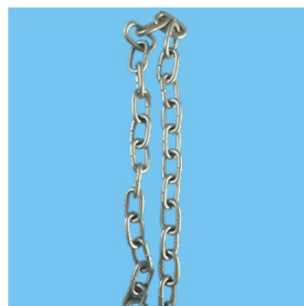

Size(d) mm	2	2	2.5	2.5	3	3	3.5	3.5	4	4	4.5	4.5
A	12	22	14	24	16	26	18	28	19	32	20	34
B	8	8	10	10	12	12	14	14	16	16	18	18
Weight Per 100M (kg)	7	6	11	10	16.5	15	22.5	20	30	27	39.5	35
Size(d) mm	5	5	5.5	5.5	6	6	6.5	6.5	7	7	8	8
A	21	35	23	38.5	24	42	26	45.5	28	49	32	52
B	50	43	60.5	52	73	63	86	74	100	86	130	110
Size(d) mm	8.5	8.5	9	9	10	10	11	11	12	12	13	13
A	34	56	36	59	40	65	44	72	48	78	52	82
B	34	34	36	36	40	40	44	44	48	48	52	52
Weight Per 100M (kg)	149	125	165	141	205	175	250	211	290	255	345	295

Material:Carbon steel

## MTM 0704 Knotted Chain5686

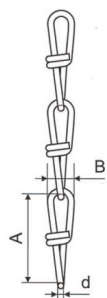
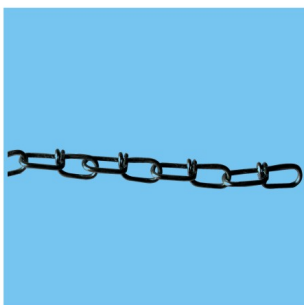

Size	14	16	20	22	25	27	30
d (mm)	1.4	1.6	1.8	2	2.2	2.5	2.8
A	22.8	26.2	30.1	32	35.4	40	44.6
B	3.7	3.8	4.4	5	5.6	6	6.9
Weight Per 100FT (kgs)	4.2	6	7.3	9	11	14	17
WLL (lbs)	35.2	48.4	66	88	110	154	198
Size	32	35	40	45	50	55	
d (mm)	3.1	3.4	3.8	4.2	4.6	5	
A	47.2	50.8	53.6	60.4	67.2	70	
B	7.8	8.7	9.4	10.6	11.3	12.5	
Weight Per 100FT (kgs)	21	26	34	41	50	57	
WLL (lbs)	264	308	352	374	396	418	

Material:Carbon steel





### MTM 0705 Decorator Chain-Oval Link



Dia (mm)	2.8	3.0	3.0	3.2	3.8	4.0	5.0
Outside Length (mm)	38.6	39.0	28.0	39.4	40.6	41.0	43.0
Inside Length (mm)	16.0	16.0	10.5	16.0	16.0	16.0	16.0
Weight Per 100FT (kgs)	4.0	4.6	5.5	6.5	7.8	8.5	12.8
WLL (lbs)	35.0	45.0	45.0	60.0	90.0	105.0	130.0

Material: Carbon steel

### MTM 0706 Decorator Chain-Square Rolled



Dia (mm)	1.6*1.6	2.5*2.5	3.0*3.0	3.2*3.2	4.0*4.0
Outside Length (mm)	22.4	22.0	34.3	45.7	43.0
Inside Length (mm)	6.7	5.4	6.2	12.2	10.0
Weight Per 100FT (kgs)	2.0	4.0	5.2	7.0	9.0
WLL (lbs)	15.0	30.0	50.0	60.0	80.0

Material: Carbon steel

### MTM 0707 Decorator Chain-Square Rope



Dia (mm)	2.0*2.0	3.0*3.0	4.0*4.0
Outside Length (mm)	23.8	35.1	41.5
Inside Length (mm)	5.5	8.8	10.2
Weight Per 100FT (kgs)	2.3	5.2	9.6
WLL (lbs)	26.0	44.0	76

Material: Carbon steel

### MTM 0708 Decorator Chain-Square Link



Dia (mm)	2.0*2.0	3.0*3.0
Outside Length (mm)	28.0	48.0
Inside Length (mm)	10.5	16.0
Weight Per 100FT (kgs)	2.7	6.0
WLL (lbs)	20.0	45.0

Material: Carbon steel

### MTM 0709 Ball Chain



Dia (mm)	1.2	1.6	2.0	2.4	3.0	3.2	4.0	4.5	5.0	6.0	8.0	10.0
Weight Per 100FT (kgs)	0.1	0.2	0.3	0.4	0.6	0.6	0.9	1.1	1.5	2.0	3.1	5.0

Material: Carbon steel

## MTM 0710 Steel Wire Rope DIN 3055

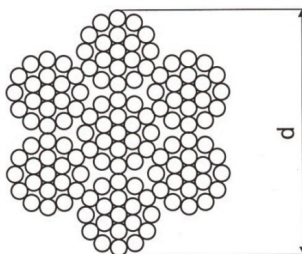
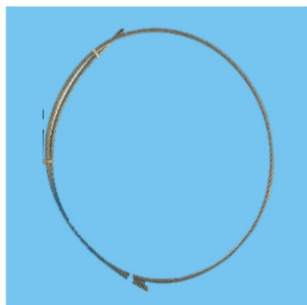

SIZE (mm)	SWR 1	SWR 1.5	SWR 2	SWR 2.5	SWR 3	SWR 4	SWR 5
PACK (m/reel)	200	200	200	200	200	200	100
Weight Per M (kgs)	0.0042	0.008	0.014	0.022	0.032	0.056	0.088
SIZE (mm)	SWR 6	SWR 8	SWR 10	SWR 12	SWR 14	SWR 16	
PACK (m/reel)	100	100	100	100	100	100	
Weight Per M (kgs)	0.126	0.225	0.351	0.502	0.683	0.892	
SIZE (mm)	SWR PVC 1/2	SWR PVC 1.5/2.5	SWR PVC 2/3	SWR PVC 3/4	SWR PVC 4/5	SWR PVC 5/6	SWR PVC 6/8
PACK (m/reel)	200	200	200	200	200	100	100
Weight Per M (kgs)	0.005	0.012	0.015	0.036	0.08	0.103	0.192
SIZE (mm)	SWR PVC 8/10	SWR PVC 10/12					
PACK (m/reel)	100	100					
Weight Per M (kgs)	0.27	0.35					

Material: Carbon steel

## MTM 0711 Nylon Pulley 502 With Single Wheel

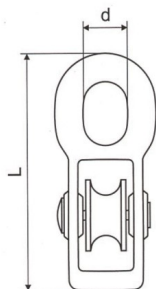

Size	15	20	25	30	40	50	65
d (mm)	10	11	12	13	14	16	20
L (mm)	50	60	70	80	93	113	135

Material: Body: Zinc Alloy  
Wheel: Nylon

## MTM 0712 Nylon Pulley 504 With Double Wheel

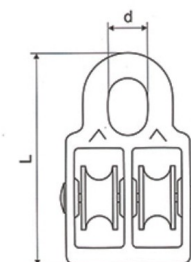
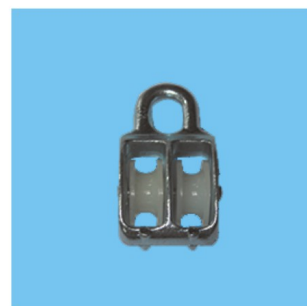

Size	15	20	25	30	40	50
d (mm)	10	11	12	13	14	16
L (mm)	50	60	70	80	93	113

Material: Body: Zinc Alloy  
Wheel: Nylon

## MTM 0713 Nickel Plated Swivel Eye U.S. Type Pulley With Single Wheel

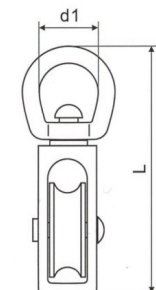

Size (in)	1/2"	3/4"	1"	1-1/4"	1-1/2"	2"
d (mm)	9	9	9	21	21	21
L (mm)	50	50	63	88	88	105

Material: Nickel plated





### MTM 0714 Nickel Plated Swivel Eye U.S. Type Pulley With Double Wheel

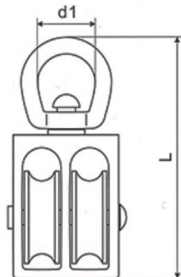

Size (in)	1/2"	3/4"	1"	1-1/4"	1-1/2"	2"
d (mm)	9	9	9	21	21	21
L (mm)	50	50	63	88	88	105

Material: Nickel plated

### MTM 0715 Nickel Plated Fixed Pulley With Single Wheel

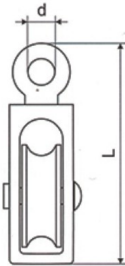

Size (in)	1/2"	3/4"	1"	1-1/4"	1-1/2"	2"
d (mm)	5	5	6.5	10	10	13
L (mm)	41	41	54	76.5	76.5	98.5

Material: Nickel plated

### MTM 0716 Nickel Plated Fixed Pulley With Double Wheel

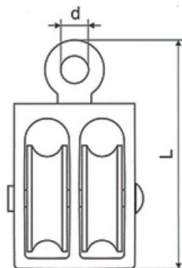

Size (in)	1/2"	3/4"	1"	1-1/4"	1-1/2"	2"
d (mm)	5	5	6.5	10	10	13
L (mm)	41	41	54	76.5	76.5	98.5

Material: Nickel plated

### MTM 0717 Wire Stretcher

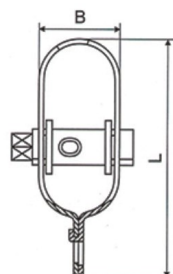
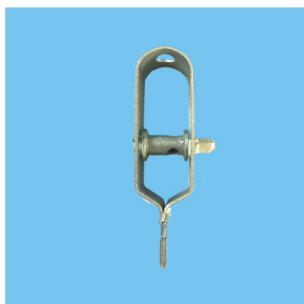

Size (mm)	100	120	130
L (mm)	100	120	130
B (mm)	30	30	42

Material: Carbon steel

## MTM S0101 Commercial Dee Shackle

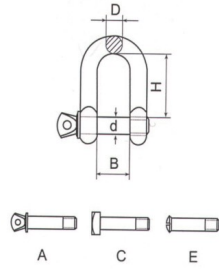

Size(D) mm	3	4	5	6	8	10	12
d	3	4	5	6	8	10	12
B	8	8	10	12	16	20	24
H	12	16	20	24	32	40	48
Size(D) mm	14	16	19	22	25	28	32
d	14	16	19	22	25	28	32
B	28	32	38	44	50	56	64
H	56	64	76	88	100	112	128

Material: Stainless steel 304/Stainless steel 316

## MTM S0102 Commercial Bow Shackle

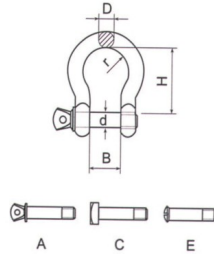

Size(D) mm	3	4	5	6	8	10	12
d	3	4	5	6	8	10	12
B	6	8	10	12	16	20	24
H	12	16	20	24	32	40	48
2r	9	12	15	18	24	30	36
Size(D) mm	14	16	19	22	25	28	32
d	14	16	19	22	25	28	32
B	28	32	38	44	50	56	64
H	56	64	76	88	100	112	128
2r	42	48	57	66	75	84	96

Material: Stainless steel 304/Stainless steel 316

## MTM S0103 Oversize Chain Dee Shackle

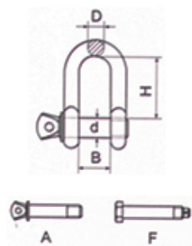

Size(D) in	3/16"	1/4"	5/16"	3/8"	7/16"	1/2"	5/8"	3/4"	7/8"	1"
d (mm)	6.25	7.8	9.4	11	12.5	15.7	19	22.2	25.4	28.5
B (mm)	9.52	11.9	13.5	15.9	20.6	20.6	27	30.2	38.1	41.3
H (mm)	22	26	30	37	44	50	60	70	85	97

Material: Stainless steel 304/Stainless steel 316



### MTM S0104 Oversize Anchor Bow Shackle

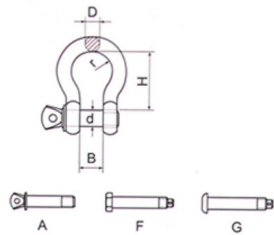
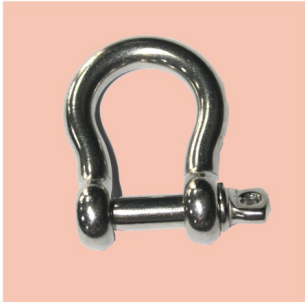

Size(D) in	3/16"	1/4"	5/16"	3/8"	7/16"	1/2"	5/8"	3/4"	7/8"	1"
d (mm)	6.25	7.8	9.4	11	12.5	15.7	19	22.2	25.4	28.5
B (mm)	9.52	11.9	13.5	15.9	20.6	20.6	27	30.2	38.1	41.3
H (mm)	25.4	31	36.5	42	49.2	55.6	68.3	84.1	100	112.7

Material: Stainless steel 304/Stainless steel 316

### MTM S0105 Halyard Shackle ( Locking Pin)

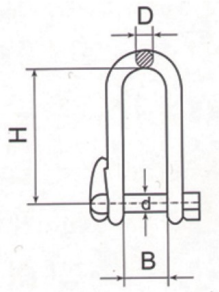

Size(D) mm	5	6	8
d	5	6	8
B	13	16	22
H	40.5	46	64

Material: Stainless steel 304/Stainless steel 316

### MTM S0106 Halyard Shackle ( Locking Pin and Cross Bar)

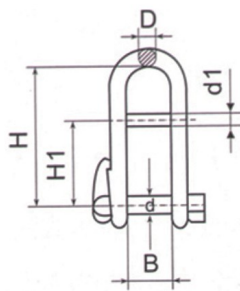
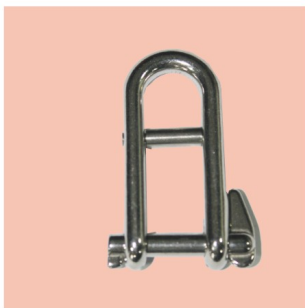

Size(D) mm	5	6	8
d	5	6	8
B	13	16	22
H1	24.5	28	40
H	40.5	46	64
d1	4	5	6

Material: Stainless steel 304/Stainless steel 316

### MTM S0107 Fixed Snap Shackle

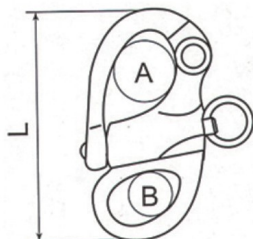

Size (mm)	0	1	2	3
A	6.5	16	21	21
B	32	56	70	102
L	9	12	19	25

Material: Stainless steel 304/Stainless steel 316

## MTM S0108 Swivel Snap Shackle With Round Head

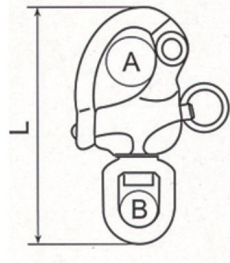

Size (mm)	1	2	3
A	12	16	22
B	67	87	126
L	14	20	27

Material: Stainless steel 304/Stainless steel 316

## MTM S0109 Swivel Snap Shackle With Jaw Head

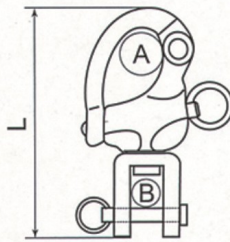

Size (mm)	1	2	3
A	13	13	22
B	70	87	127
L	14	20	27

Material: Stainless steel 304/Stainless steel 316

## MTM S0110 Swivel Snap Shackle With Tiger Head

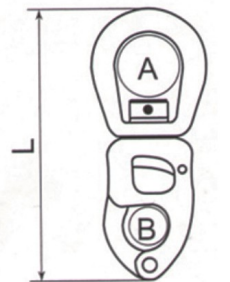
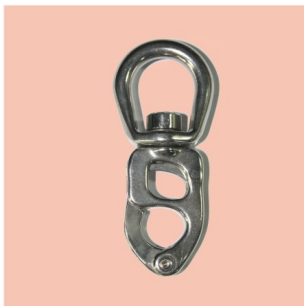

Size (L)	85	100	115
A	20	23	27
B	13	16	18

Material: Stainless steel 304/Stainless steel 316

## MTM S0111 Twist Shackle

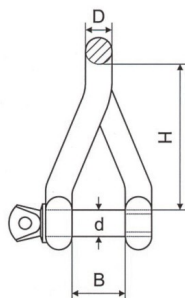

Size (D) mm	4	5	6	8	10	12
d	4	5	6	8	10	12
B	8	10	12	16	20	25
H	24	30	36	44	51	66

Material: Stainless steel 304/Stainless steel 316



### MTM S0201 Jis Frame Type Turnbuckle

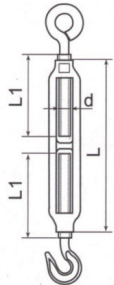

Size(d) mm	M5	M6	M8	M10	M12	M16	M20
L	70	100	125	150	200	250	300
L1	35	44	59	73	95	116	145

Material: Stainless steel 304/Stainless steel 316

### MTM S0202 Turnbuckle DIN1480

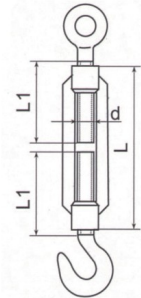

Size(d) mm	M5	M6	M8	M10	M12	M16	M20
L	70	110	110	125	125	170	200
L1	35	55	57	68	70	88	105

Material: Stainless steel 304/Stainless steel 316

### MTM S0203 Pipe Turnbuckle, Jaw and Swage Stud

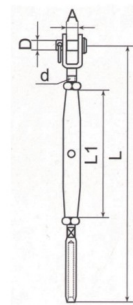

Size(d) mm	M5	M6	M8	M10	M12	M14	M16	M20
L	150	170	205	240	295	325	370	405
L1	80	90	105	125	150	165	190	210
A	6	7.5	10	12	14	14	16	20
D	5.5	6.3	7.5	9.1	12.5	14.3	16.1	17.8
ROPE(Φ)	2.5	3	4	5	6	7	8	10

Material: Stainless steel 304/Stainless steel 316

### MTM S0204 Pipe Turnbuckle (Jaw and Jaw)

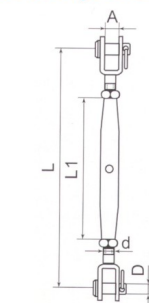

Size(d) mm	M5	M6	M8	M10	M12	M14	M16	M20
L	115	142	160	200	245	280	304	350
L1	80	90	105	125	150	165	190	210
A	6	7.5	10	12	14	14	16	20
D	5.2	6.2	8.7	9.7	12.6	12.6	16	19

Material: Stainless steel 304/Stainless steel 316



## MTM S0205 Turnbuckle Body DIN1479

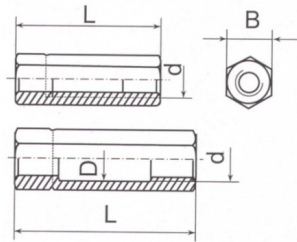
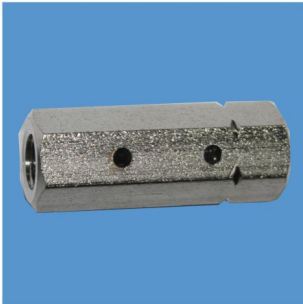

Size(d) mm	M6	M8	M10	M12	M16	M20	M24	M30
L	30	35	45	55	75	95	115	125
B	10	13	17	19	24	30	36	46
D						21	26	32

Material: Stainless steel 304/Stainless steel 316

## MTM S0206 Closed Body Turnbuckle With Two Terminals

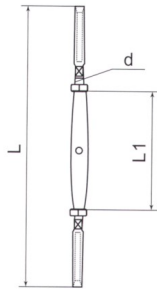

Size(d) mm	M5	M6	M8	M10	M12	M14	M16	M20
L	155	185	215	275	320	350	390	445
L1	80	95	105	125	150	165	190	210
ROPE(Φ)	2.5	3	4	5	6	7	8	10

Material: Stainless steel 304/Stainless steel 316

## MTM S0207 Closed Body Turnbuckle With Movable Jaw and Terminal

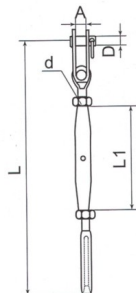

Size(d)MM	M5	M6	M8	M10	M12	M16M	M20
L	148	176	208	250	297	396	458
L1	80	95	105	125	150	190	210
A	5.5	6.5	9	12	13	18	22
D	5	6	8	9	12	16	19
ROPE(Φ)	2.5	3	4	5	6	8	10

Material: Stainless steel 304/Stainless steel 316



### MTM S0301 Wire Rope Clip DIN741

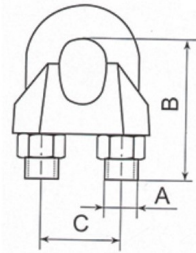

Size mm	M2	M3	M4	M5	M6	M8	M10	M11
B	15	16	18.5	19	23	28	34	36
C	6.6	9	9	11	13	16	19	20
A	M3	M4	M4	M5	M5	M6	M8	M8
Size mm	M13	M14	M16	M19	M22	M26	M30	
B	45	47	51	63	71	81	94	
C	24	25	29	32	37	41	48	
A	M10	M10	M12	M12	M14	M14	M16	

Material: Stainless steel 304/Stainless steel 316

### MTM S0302 Jis Type Wire Rope Clip

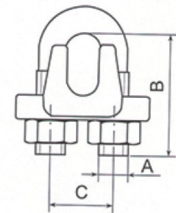

Size mm	M2	M3	M4	M5	M6	M8	M10	M12	M16
B	15	17	20.5	20.5	27.5	33	41	49	62.5
C	7	8	10	12	14	18	22	26	32
A	M3	M4	M4	M5	M6	M8	M10	M12	M14

Material: Stainless steel 304/Stainless steel 316

### MTM S0303 Simplex Wire Rope Clip

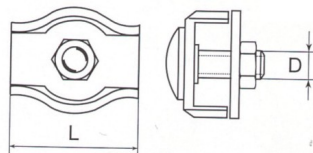

Size mm	M2	M3	M4	M5	M6	M8	M10
L	18.5	20	22.5	26	30	36	42
D	M4	M4	M5	M6	M6	M8	M10

Material: Stainless steel 304/Stainless steel 316

### MTM S0304 Duplex Wire Rope Clip

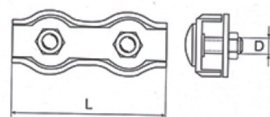

Size mm	M2	M3	M4	M5	M6	M8	M10
L	37	40	45	52	60	72	84
D	M4	M4	M5	M6	M6	M8	M10

Material: Stainless steel 304/Stainless steel 316

## MTM S0305 Thimble DIN6899 Form A

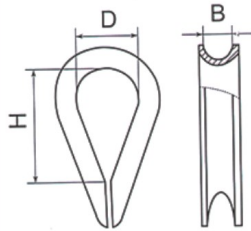

Size mm	1.8x2	2x2.5	2.5x3	3x3.5	3.5x4	4x5	5x6	6x7	7x8	8x9
D	8	9	10	11	12	13	14	15	16	18
H	17	19	21	23	26	28	30	33	35	39
B	2	2.5	3	3.5	4	5	6	7	8	9
Size mm	9x10	10x11	11x12	12x13	13x14	15x16	16x19	18x20	20x22	
D	20	22	24	26	28	32	35	40	44	
H	43	47	51	56	61	69	78	86	95	
B	10	11	12	13	14	16	19	20	22	

Material: Stainless steel 304/Stainless steel 316

## MTM S0306 Thimble DIN6899 Form B

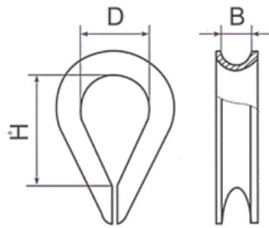

Size mm	2.5x3	3.5x4	4x5	5x6	6x7	7x8	9x10	10x12
D	12	13	14	16	18	20	24	28
H	19	21	23	25	28	32	38	45
B	3	4	5	6	7	8	10	12
Size mm	12x13	13x14	15x16	16x18	18x20	20x22	22x24	24x26
D	30	32	36	40	45	50	56	62
H	48	51	58	64	72	80	90	99
B	13	14	16	18	20	22	24	26

Material: Stainless steel 304/Stainless steel 316

## MTM S0307 European Type Thimble

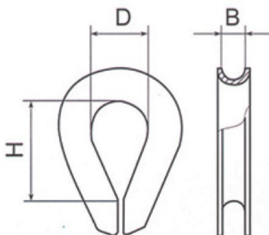

Size mm	2	2.5	3	4	5	6	7
D	9	9.5	10	11	13	16	18
H	15	15.5	16	17	20	25	28
B	2	2.5	3	4	5	6	7
Size mm	8	10	12	14	16	18	20
D	20	26	28	34	37	42	45
H	32	40	45	56	62	65	78
B	8	10	12	14	16	18	20

Material: Stainless steel 304/Stainless steel 316





### MTM S0501 Eye Bolt DIN580

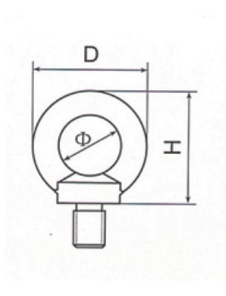
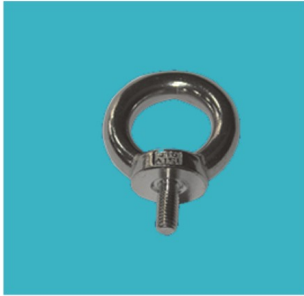

Size(d) mm	M6	M8	M10	M12	M16	M20	M24	M30	M36
D	36	36	45	54	63	72	90	108	126
Φ	16	20	25	30	35	40	50	60	70
H	28	33	42	51	60	69	87	105	123

Material: Stainless steel 304/Stainless steel 316

### MTM S0502 Eye Nut DIN582

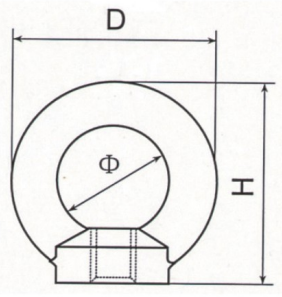

Size(d) mm	M6	M8	M10	M12	M16	M20	M24	M30
D	36	36	45	54	63	72	90	108
Φ	16	20	25	30	35	40	50	60
H	28	33	42	51	60	69	87	105

Material: Stainless steel 304/Stainless steel 316

### MTM S0503 Long Type Eye Bolt With Once Washer and One Nut

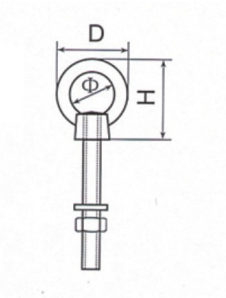
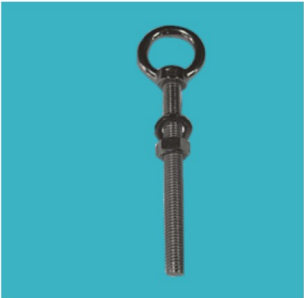

Size(d) mm	M6x40	M6x60	M6x80	M8x80	M8x100	M10x100	M12x120
D	26	26	26	31	31	39	45
Φ	16	16	16	19	19	25	29
H	30	30	30	34	34	42	47

Material: Stainless steel 304/Stainless steel 316

### MTM S0503A Eye Nut With Screw

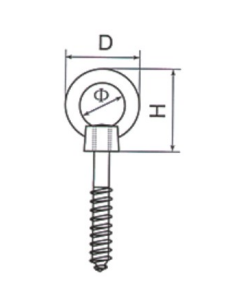
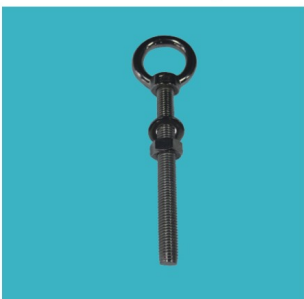

Size(d) mm	5x50	6x60	8x80	10x60	10x100	12x120
D	26	26	31	39	39	45
Φ	16	16	19	25	25	29
H	30	30	34	42	42	47

Material: Stainless steel 304/Stainless steel 316

### MTM S0504 Welded Eye With One Washer and Nut

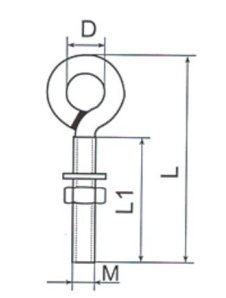
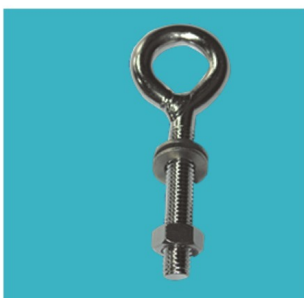

Size(d) mm	M6x60	M6x80	M8x60	M8x80	M8x100	M10x100	M10x120
D	13	13	17	17	17	21	21
L1	30	50	22	42	62	55	75

Material: Stainless steel 304/Stainless steel 316

## MTM S0505 Welded Eye With Round Ring

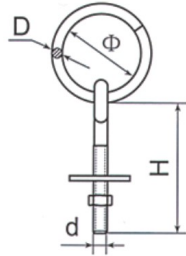

Size(d) mm	M5X50	M6X60	M6X80	M6X100	M8X60	M8X80
D	5	6	6	6	8	8
Φ	30	35	35	35	45	45
Size(d) mm	M8X100	M8X120	M8X150	M10X100	M10X120	M10X150
D	8	8	8	9	9	9
Φ	45	45	45	50	50	50
Size(d) mm	M12X110	M12X120	M12X150	M12X180	M12X200	
D	12	12	12	12	12	
Φ	60	60	60	60	60	

Material: Stainless steel 304/Stainless steel 316

## MTM S0506 Welded Wooden Thread Eye

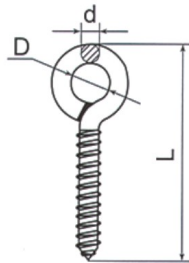
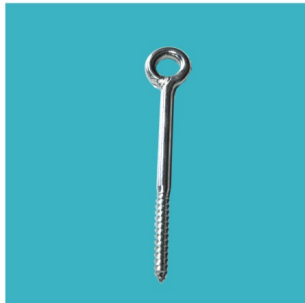

Size(d) mm	6	6	8	8	8	10	10
L	60	80	60	80	100	100	120
D	12	12	15	15	15	18	18

Material: Stainless steel 304/Stainless steel 316

## MTM S0507 Welded Wooden Threaded Eye With Round Ring

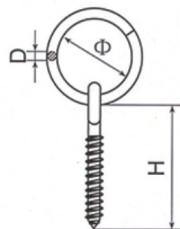
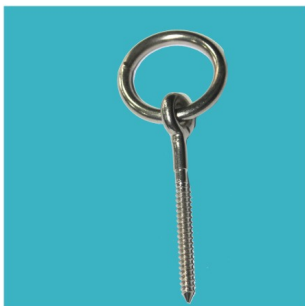

Size(d) mm	6	8	10	12
D	6	8	9	12
Φ	35	45	50	60
H	75	75	100	120

Material: Stainless steel 304/Stainless steel 316

## MTM S0508 European Type Swivel With Eye and Jaw

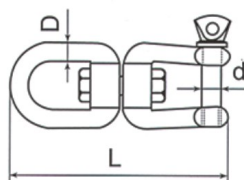
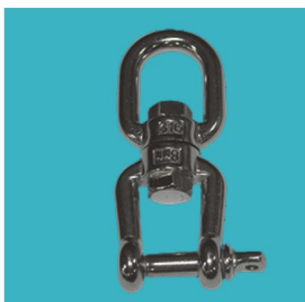

Size(d) mm	5	6	8	10	13	16	19
D	5	6	8	10	13	16	19
d	5	6	8	10	13	16	19
L	59	66	94	118	152	188	229

Material: Stainless steel 304/Stainless steel 316



### MTM S0509 European Type Swivel With Eye and Eye

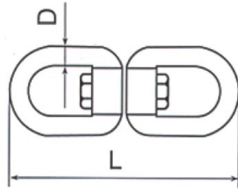
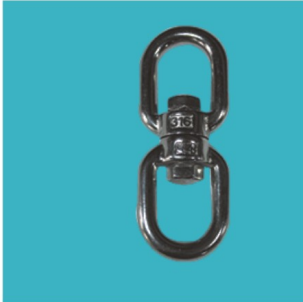

Size(d) mm	5	6	8	10	13	16	19
D	5	6	8	10	13	16	19
L	59	66	90	115	154	188	229

Material: Stainless steel 304/Stainless steel 316

### MTM S0510 European Type Swivel With Jaw and Jaw

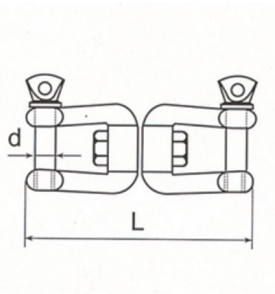
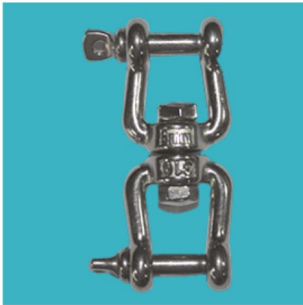

Size(d) mm	5	6	8	10	13	16	19
d	5	6	8	10	13	16	19
L	59	66	94	118	152	188	229

Material: Stainless steel 304/Stainless steel 316

### MTM S0511 Metric Thread Eye Screw DIN444

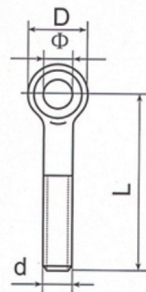
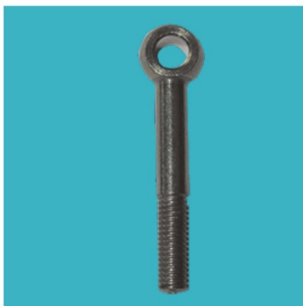

Size(d) mm	M5	M6	M8	M10	M12	M16	M20	M24
Φ	5	6	8	10	12	16	18	22
D	12	14	18	20	25	32	40	45
L	30~80	35~90	40~140	45~150	55~200	65~260	100~260	100~260

Material: Stainless steel 304/Stainless steel 316

### MTM S0512 Wooden Thread Eye Screw

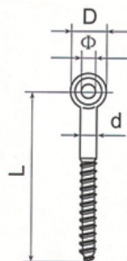
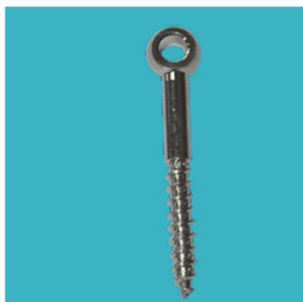

Size(d) mm	5	6	8	10	12	16	20	24
Φ	5	6	8	10	12	16	18	22
D	12	14	18	20	25	32	40	45
L	30~80	35~90	40~140	45~150	55~200	65~260	100~260	100~260

Material: Stainless steel 304/Stainless steel 316

## MTM S0601 Snap Hook DIN5299 Form A

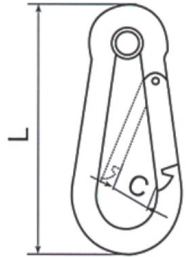

Size mm	4	5	6	7	8	9	10	11	12	13	14	15
D	40	50	60	70	80	90	100	120	140	160	180	200
L	7	7	8	8	9	10	11	16	19	25	35	35

Material: Stainless steel 304/Stainless steel 316

## MTM S0602 Snap Hook DIN5299 Form B

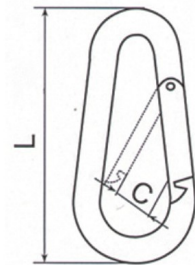

Size mm	4	5	6	7	8	9	10	11	12	13	14	15
D	40	50	60	70	80	90	100	120	140	160	180	200
L	7	7	8	8	9	10	11	16	19	25	35	35

Material: Stainless steel 304/Stainless steel 316

## MTM S0603 Snap Hook DIN5299 Form C

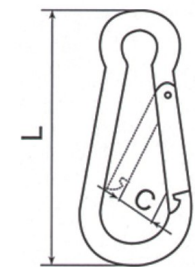

Size mm	4	5	6	7	8	9	10	11	12	13	14	15
D	40	50	60	70	80	90	100	120	140	160	180	200
L	7	7	8	8	9	10	11	16	19	25	35	35

Material: Stainless steel 304/Stainless steel 316

## MTM S0604 Snap Hook DIN5299 Form D

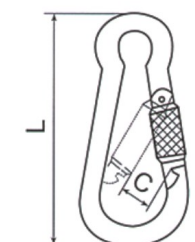

Size mm	4	5	6	7	8	9	10	11	12	13	14	15
D	40	50	60	70	80	90	100	120	140	160	180	200
L	7	7	8	8	9	10	11	16	19	25	35	35

Material: Stainless steel 304/Stainless steel 316



### MTM S0605 S Hook

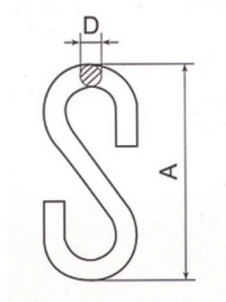

Size(D) mm	3	4	5	6	8	10	12
A	30	40	50	60	80	100	120

Material: Stainless steel 304/Stainless steel 316

### MTM S0606 Pelican Hook

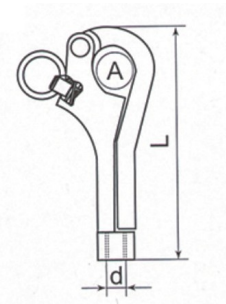
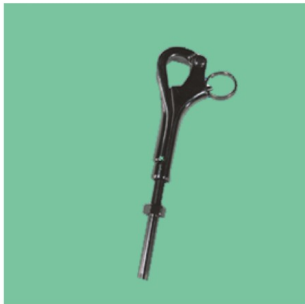

Size mm	M6	M8	M12
A	12	16	25
L	76	102	152

Material: Stainless steel 304/Stainless steel 316

### MTM S0607 Rigid Eye Snap

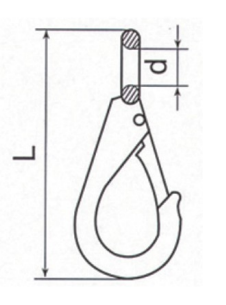
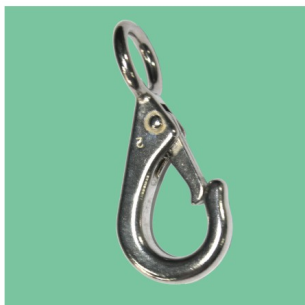

Size	0	1	2	3
d (mm)	10	16	19	19
L (mm)	53.5	73	81.5	98

Material: Stainless steel 304/Stainless steel 316

### MTM S0608 Swivel Eye Snap

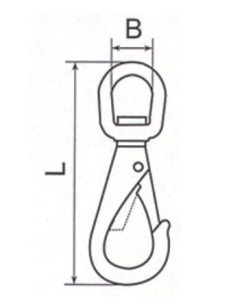
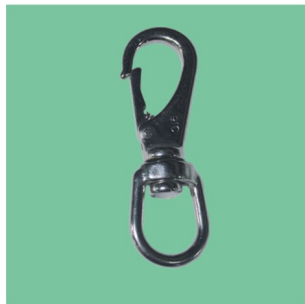

Size	0	1	2	3
d (mm)	16.5	19.5	20.5	19.5
L (mm)	69	85	99	117.5

Material: Stainless steel 304/Stainless steel 316

## MTM S0609 Egg Shaped Hook

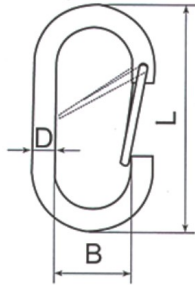

Size(D) mm	5	6	8	10
B	15	20	22	24
L	50	60	70	80

Material: Stainless steel 304/Stainless steel 316

## MTM S0610 Big Eye Spring Hook

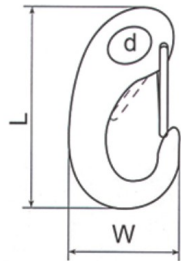
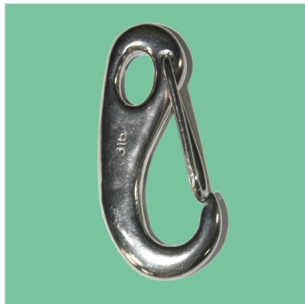

Size(L) mm	32	50	70	100
W	17	25	31	50
d	4	6.6	9	13.8

Material: Stainless steel 304/Stainless steel 316

## MTM S0611 Open End Spring Hook

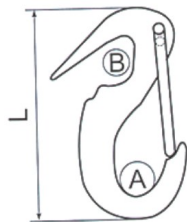
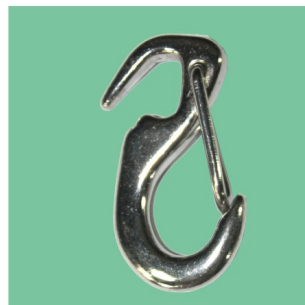

Size mm	50	55	65	90
A	7.5	9	11	17
B	6.5	8	10	13
L	50	55	65	90

Material: Stainless steel 304/Stainless steel 316

## MTM S0612 Quick Link

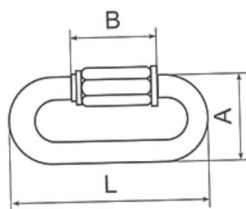

Size mm	3.5	4	5	6	7	8	9	10	11	12
L	36	39.5	48	57	66	76	83	89	98	107
A	17	19	23	26	30	34	37	40	45	49
B	11.5	12.5	15	19	21	23	26	29	30	32

Material: Stainless steel 304/Stainless steel 316





### MTM S0613 Quick Link(Large Opening Type)

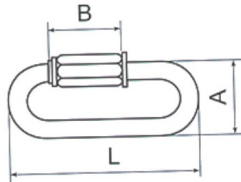

Size mm	3.5	4	5	6	7	8	9	10	12
L	46	53	62	70.5	79	89	97	108.5	126
A	18	20.6	24	28	31	35	38	42	49
B	17	20	23	26	29	32.5	34	37.5	45

Material: Stainless steel 304/Stainless steel 316

### MTM S0614 Swivel Head Key Snap

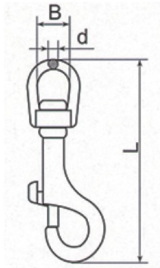

Size	68	76	85	92	120
B	14	14	18	18	33
d	4	4	5	5	6.5
L	68	76	85	92	120

Material: Stainless steel 304/Stainless steel 316

### MTM S0615 Swivel Head Clamp Hook

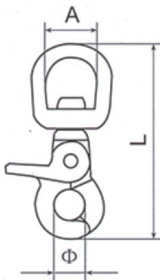
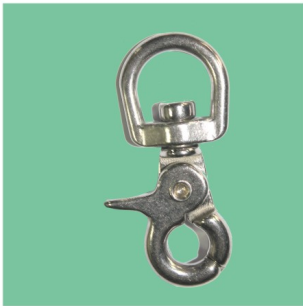

Size in	1/2"	5/8"	1"
L	66.5	69.5	70
A	13	16.8	25.4
φ	12	12	12

Material: Stainless steel 304/Stainless steel 316

### MTM S0616 Pelican Hook With Ring

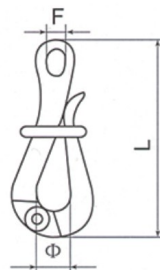
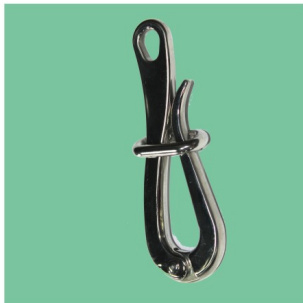

Size in	4"	6"
L	100	150
F	10	13
φ	18	22

Material: Stainless steel 304/Stainless steel 316

## MTM S0701 Fork Terminal

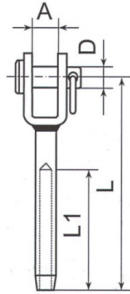

Size mm	2.5	3	4	5	6	7	8	9.5	10	12
A	6	7.5	10	12	14	14.5	16	17	17	20
D	5.2	5.2	6.2	8.7	9.7	12.6	14.6	16.5	16.5	19
L1	24	32	40	57	63	70	85	87	89	105
L1	55	65	77	88	106	116	145	150	150	176

Material: Stainless steel 304/Stainless steel 316

## MTM S0702 Eye Terminal

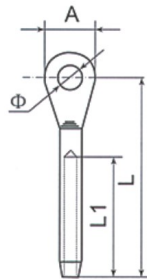
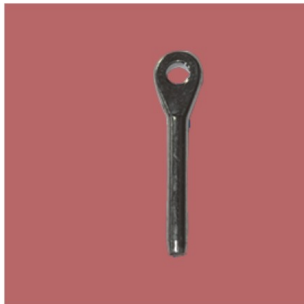

Size mm	2.5	3	4	5	6	7	8	10	12	14	16
A	13	13	18	22	28	28	32	36	39	46	52
φ	6	6.5	8	10	12.5	12.7	14.5	16.4	19.3	23	26
L1	30	36	39	50	62	68	85	90	105	140	160
L1	44.5	57.5	65	80	94	105	124	142	159	219	261

Material: Stainless steel 304/Stainless steel 316

## MTM S0703 Swage Stud

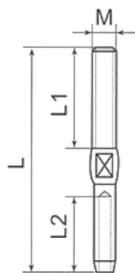

Size mm	2.5	2.5	3	4	4	5	5	6	6	7	7	8
M	M5	M6	M6	M6	M8	M8	M10	M10	M12	M12	M12	M12
L	70	72	80	95	102	120	130	136	142	148	160	165
L1	38	40	40	44	52	52	63	63	68	68	79	79
L2	24	24	32	40	40	57	57	63	63	70	70	76
Size mm	8	9.5	10	10	12	16	18	20	22	24	28	32
M	M16	M16	M16	M20	M20	M24	M30	M30	M36	M42	M42	M48
L	175	190	190	215	245	355	400	400	460	500	530	575
L1	89	89	89	105	130	165	190	190	230	250	250	250
L2	76	89	89	90	100	160	170	170	190	205	240	275

Material: Stainless steel 304/Stainless steel 316

## MTM S0703A Swage Terminal

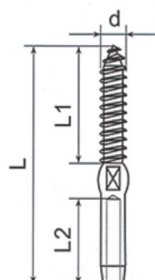

Size mm	3.2	4
d	6	6
L	90	106
L1	40	50
L2	32	40

Material: Stainless steel 304/Stainless steel 316



### MTM S0704 Toggle

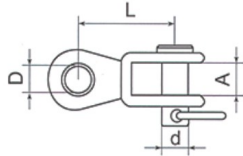

Size mm	5	6	8	9	12	14	16
D	5.5	6.5	8.5	10	13	15	16.5
A	5.5	6	9	11	12.5	13	15
L	22	27	31	36	50	60	80
d	5	6	8.5	9.5	13	14.5	16

Material: Stainless steel 304/Stainless steel 316

### MTM S0705 Eye Screw

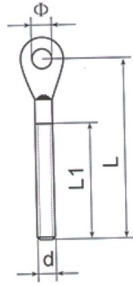

Size mm	M5	M6	M8	M10	M12	M14	M16	M20
L	63	65	78	90	110	124	133	164
L1	41	47	57	63	80	90	100	120
φ	5.5	6.5	8.5	10.5	13	13	14.5	19.5

Material: Stainless steel 304/Stainless steel 316

### MTM S0706 Welded Round Ring

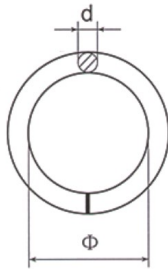

Size mm	3	4	5	6	7	8	9	10	12	13
φ	10~40	20~40	20~65	25~90	40~65	30~100	30~90	40~140	60~140	55~160

Material: Stainless steel 304/Stainless steel 316

### MTM S0707 Welded Triangular Ring

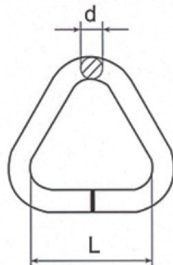
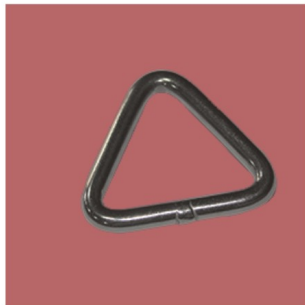

Size mm	3	4	5	5	5	6	6	6	8	8
L	35	20	30	40	45	40	45	50	45	50

Material: Stainless steel 304/Stainless steel 316

## MTM S0708 Welded D Ring

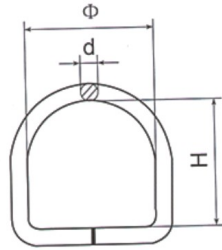

Size mm	3	4	5	6	8	9	10
Φ	15~25	20~35	25~50	30~60	50~80	50~75	50~90
H	12~22	17~32	22~47	27~57	47~77	47~72	47~87

Material: Stainless steel 304/Stainless steel 316

## MTM S0709 Repair Link

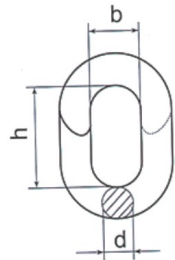

Size(d) mm	3	4	4.5	5	5.5	6	6.5	7	8	9
b	6.5	8	9	9.5	10.5	10.5	11.5	13.5	15	16.5
h	16.5	20	22	23	26	29	30	32	37	37.5

Material: Stainless steel 304/Stainless steel 316

## MTM S0710 Webbing Buckle

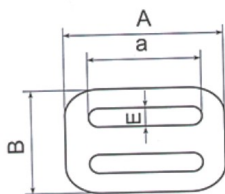

Size	1#	2#	3#
A(mm)	45	54	65
a(mm)	32	41	51
B(mm)	29	29	34
E(mm)	5	5	6

Material: Stainless steel 304/Stainless steel 316

## MTM S0711 Square Buckle

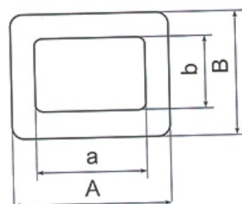

Size	4#	5#	6#
A(mm)	46	55	66
a(mm)	32	41	51
B(mm)	36	36	40.5
b(mm)	21	20	22.5

Material: Stainless steel 304/Stainless steel 316



### MTM S0712 Butterfly Hinge

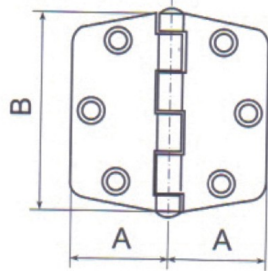

A(mm)	36.5
B	75

Material: Stainless steel 304/Stainless steel 316

### MTM S0713 Square Hinge

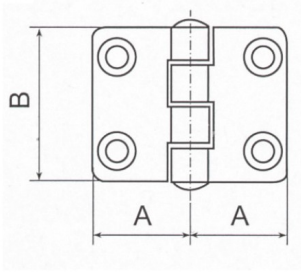

A(mm)	23
B	37

Material: Stainless steel 304/Stainless steel 316

### MTM S0714 Oblong Hinge

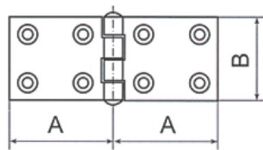

A(mm)	55.5
B	45

Material: Stainless steel 304/Stainless steel 316

### MTM S0715 T Hinge

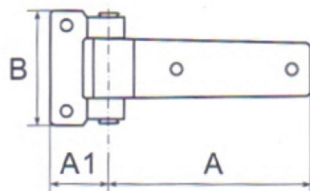

A(mm)	104
A1	30
B	59

Material: Stainless steel 304/Stainless steel 316

**MTM S0716 Wing Hinge**

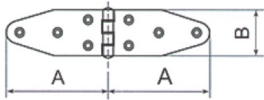

A(mm)	90
B	40

Material: Stainless steel 304/Stainless steel 316

**MTM S0717 Hinge For Key**

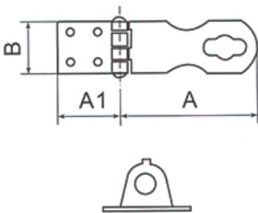

A(mm)	64
A1	29
B	24

Material: Stainless steel 304/Stainless steel 316

**MTM S0718 Hinge 01**

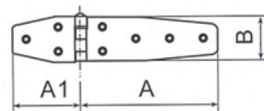

A(mm)	64
A1	29
B	24

Material: Stainless steel 304/Stainless steel 316

**MTM S0719 Hinge 02**

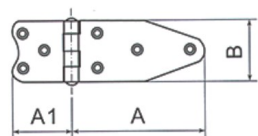

A(mm)	90
A1	40
B	40

Material: Stainless steel 304/Stainless steel 316



### MTM S0801 Square Plate With Eye

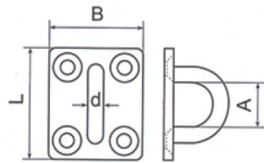

Size(d) mm	5	6	8
B	30	35	40
L	35	40	50
A	16	20	23

Material: Stainless steel 304/Stainless steel 316

### MTM S0802 Square Plate With Eye and Ring

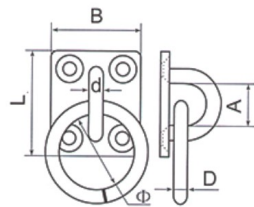

Size(d) mm	5	6	8
B	30	35	40
L	35	40	50
A	16	20	23
D	5	6	8
Φ	30	40	50

Material: Stainless steel 304/Stainless steel 316

### MTM S0803 Oval Plated With Eye

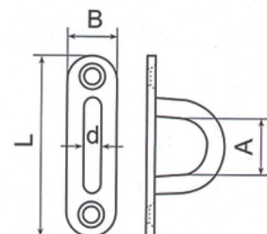

Size(d) mm	5	6	8
B	15	20	26
L	45	60	80
A	14	16	20

Material: Stainless steel 304/Stainless steel 316

MTM S0804 Oval Plate With Eye and Ring

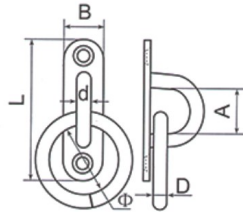

Size(d) mm	5	6	8
B	15	20	26
L	45	60	80
A	14	16	20
$\Phi$	30	40	50
D	5	6	8

Material: Stainless steel 304/Stainless steel 316

MTM S0805 Round Plate With Eye

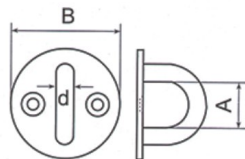

Size(d) mm	5	6	8
B	33	40	50
A	13	17	20

Material: Stainless steel 304/Stainless steel 316

MTM S0806 Round Plate With Eye and Ring

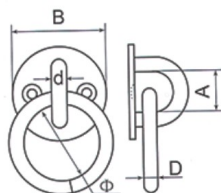

Size(d) mm	5	6	8
B	33	40	50
A	13	17	20
$\Phi$	30	40	50
D	5	6	8

Material: Stainless steel 304/Stainless steel 316



### MTM S0807 Round Plated With Eye and Screw

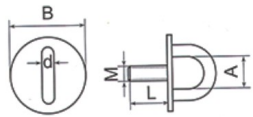

Size(d) mm	5	6	8
B	33	40	50
A	13	17	20
M	M6	M8	M10
L	20	25	25

Material: Stainless steel 304/Stainless steel 316

### MTM S0808 Round Plate With Eye Screw and Ring

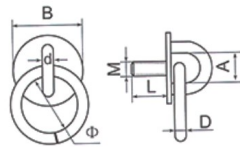

Size(d) mm	5	6	8
B	33	40	50
M	M6	M8	M10
L	20	25	25
Φ	30	40	50
A	13	17	21
D	5	6	8

Material: Stainless steel 304/Stainless steel 316

### MTM S0809 Diamond Plate With Eye

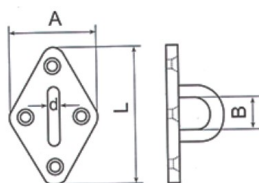

Size(d) mm	5	6	8
A	37	40	50
L	59	64	80
B	11	15	18

Material: Stainless steel 304/Stainless steel 316

### MTM S0810 Stamped Eye Strap

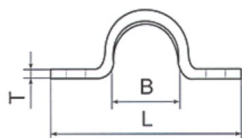

Size(T) mm	1.5	2
L	38	46
B	13	16

Material: Stainless steel 304/Stainless steel 316

**MTM S0801 DIN763 Long Link Chain**

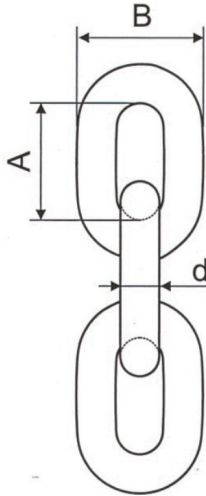

Size(d) mm	2	2.5	3	3.5	4	4.5	5
A	22	24	26	28	32	34	35
B	4	5	6	7	8	9	10
Weight Per M (kg)	0.06	0.10	0.15	0.20	0.27	0.35	0.43
Size(d) mm	6	7	8	9	10	13	16
A	42	49	52	59	65	82	100
B	12	14	16	18	20	26	32
Weight Per M (kg)	0.63	0.86	1.10	1.41	1.75	2.95	4.45

Material: Stainless steel 304/Stainless steel 316

**MTM S0802 DIN766 Short Link Chain**

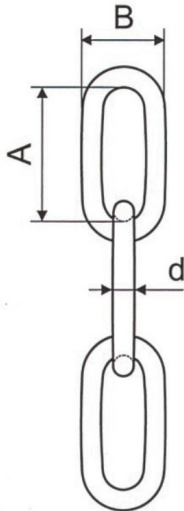

Size(d) mm	2	3	4	5	6	7	8
A	12	16	16	18.5	18.5	22	24
B	3.5	5	5	6	7.2	8.4	9.6
Weight Per M (kg)	0.07	0.16	0.32	0.50	0.80	1.10	1.40
Size(d) mm	9	10	11	12	13	16	
A	27	28	31	36	36	45	
B	10.8	12	13.2	14.6	15.6	19.2	
Weight Per M (kg)	1.80	2.30	2.68	3.11	3.80	5.70	

Material: Stainless steel 304/Stainless steel 316

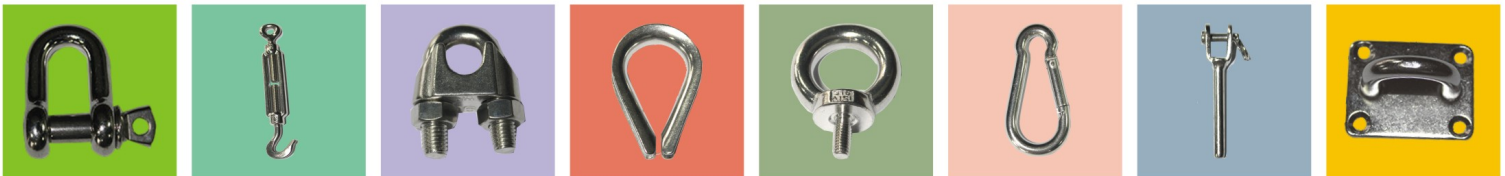

 **NINGBO MOTEPEH METAL CO.,LTD.**

1 Floor, No.18, Xingyong Road, Jiangbei District, Ningbo, China.

Tel: 86-574-87935103

Fax: 86-574-87935111

E-mail: [zyl@cn-jhwj.cn](mailto:zyl@cn-jhwj.cn)

Web: [www.hirigging.com](http://www.hirigging.com)